

KE SHI

NINGBO, CHINA
UNIVERSITY OF WASHINGTON

PORTFOLIO
OF KE SHI

SELECTED WORK
2017-2018

001

ISOLATED ISLAND

002

INSIDE THE SHELL

003

FLOATING BUBBLE

004

PAWS AT NEXT DOOR

005

OTHER PROJECTS

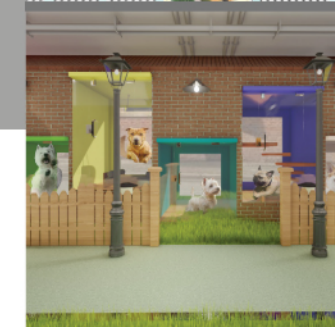
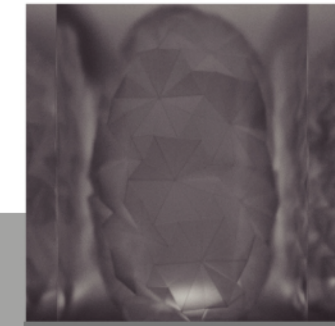

ISOLATED ISLAND

A DESIGN OF PUBLIC BATH
LOCATION: PUTUO, SHANGHAI

DESIGN BRIEF:

In some major cities, many people live as an "ant tribe". They usually live underground, and the living condition is very tough. "Isolated Island" is a space area at these "ant tribe". I hope the underground is no longer cold and hopeless, but warm and enjoyable instead. It is also a "shell" that people can temporarily escape away from the busy city.



Site analysis



TRAFFIC

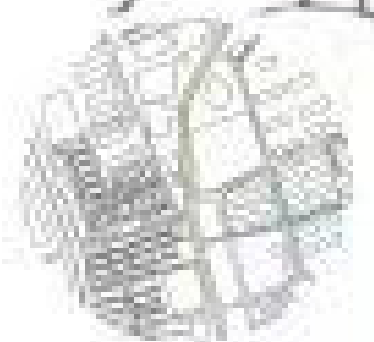

PATH

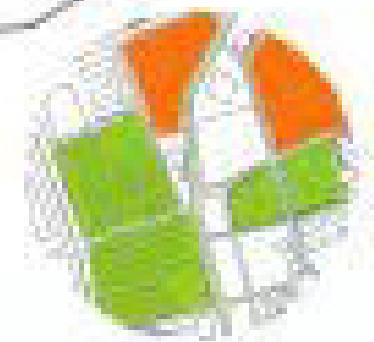

DISTRICT

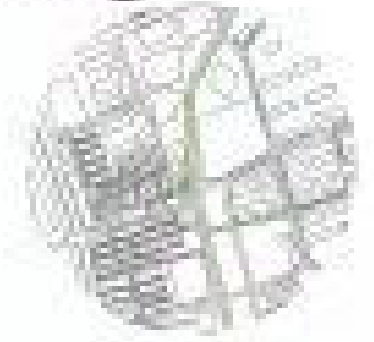

SITE LOCATION



APPROACH VIEW

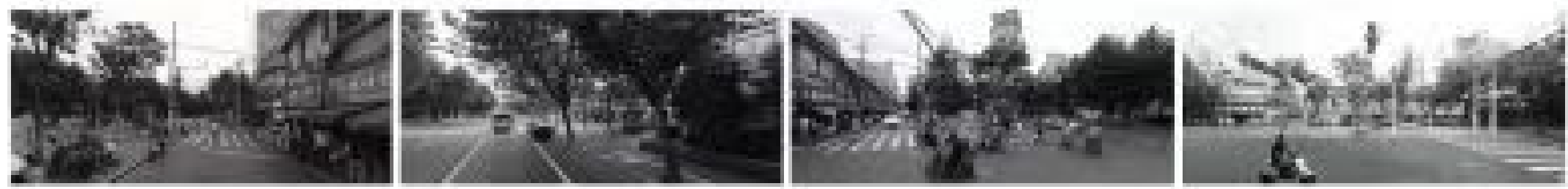

Shanghai, China

Shou Ning Road

Han Ming Road

Da Ling Road

"To find a ideal place that people can meditate and relax themselves in busy life" is my design concept. Therefore, I find this "perfect" island in between two roads as my site. I believe this forgotten under-ground space will be transformed into a "breathing" and peaceful space that customers could forget about daily chores and enjoy being alone but not lonely.

Exploded view



Concept

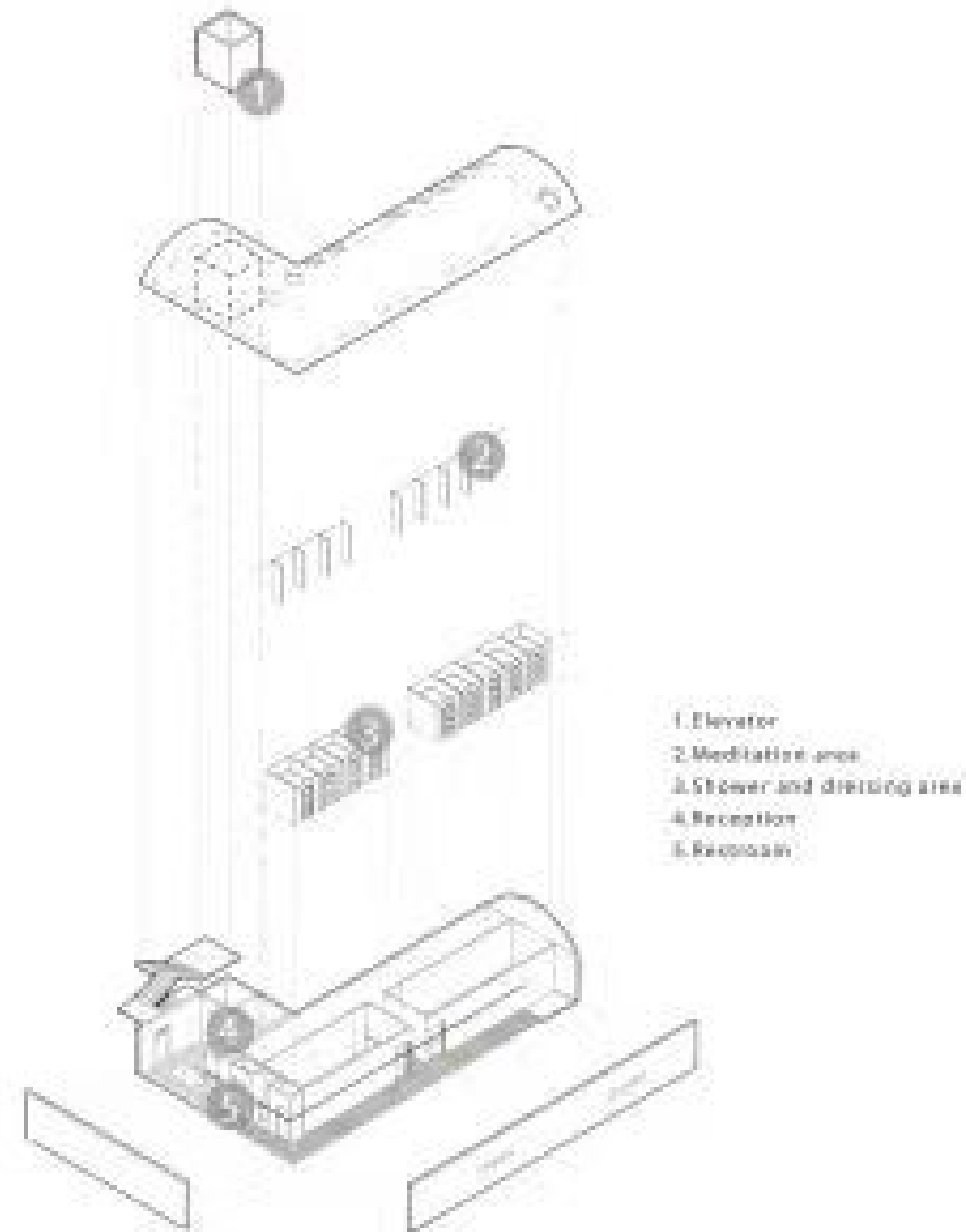

- 1. Elevator
- 2. Meditation area
- 3. Shower and dressing area
- 4. Reception
- 5. Reception

Rendering



Processing diagram

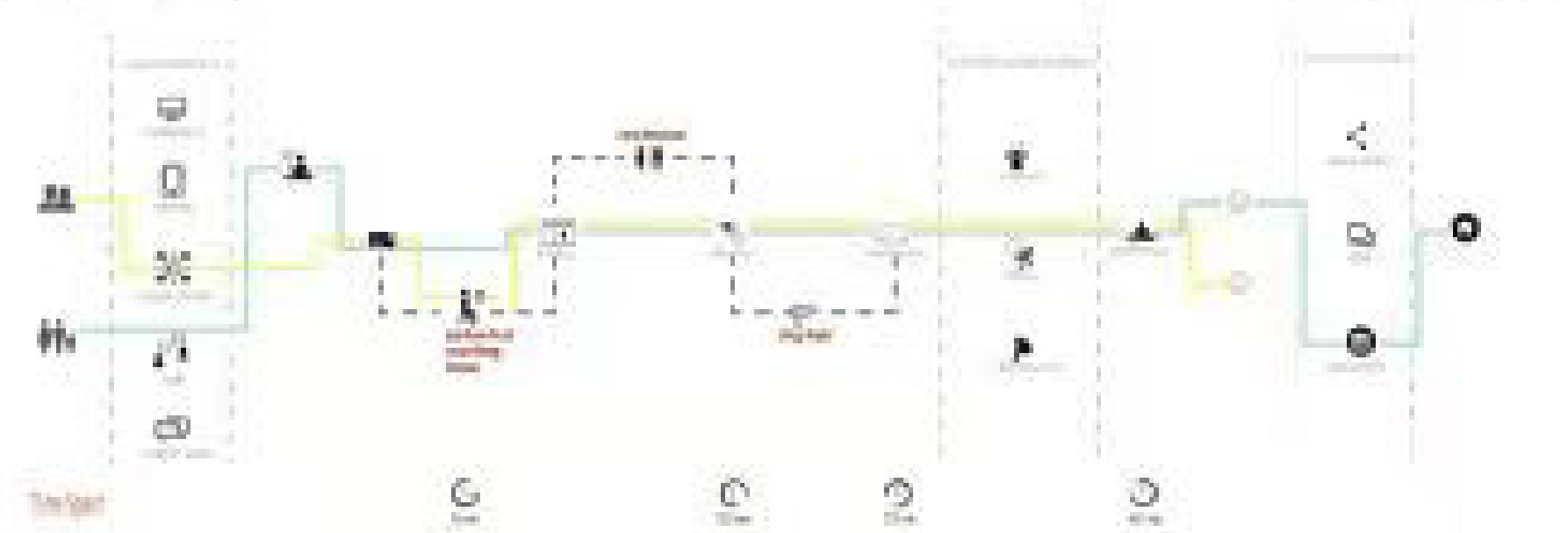

View of shower room

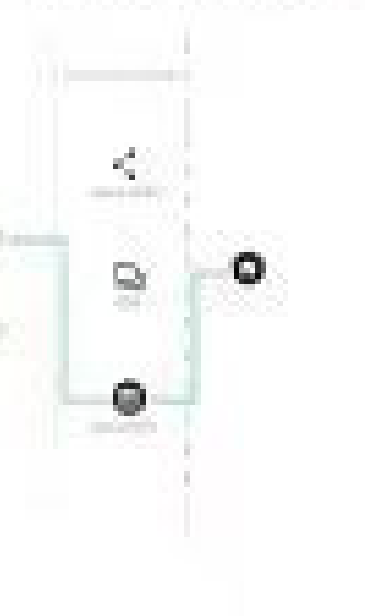

Light Installation

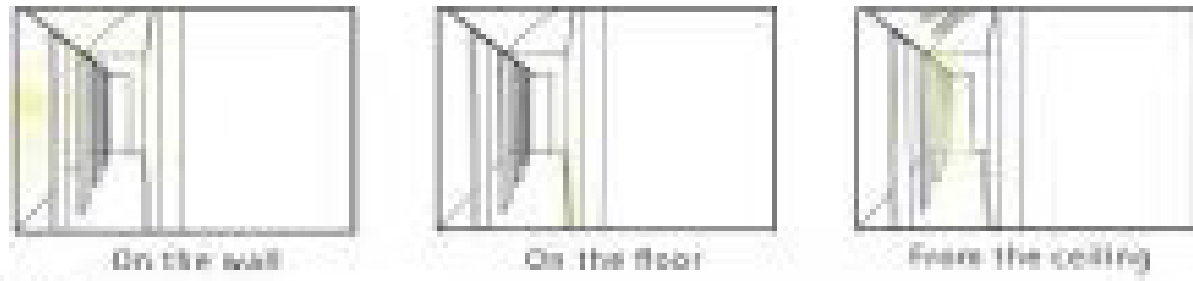

Flooring, wall and ceiling



Rendering

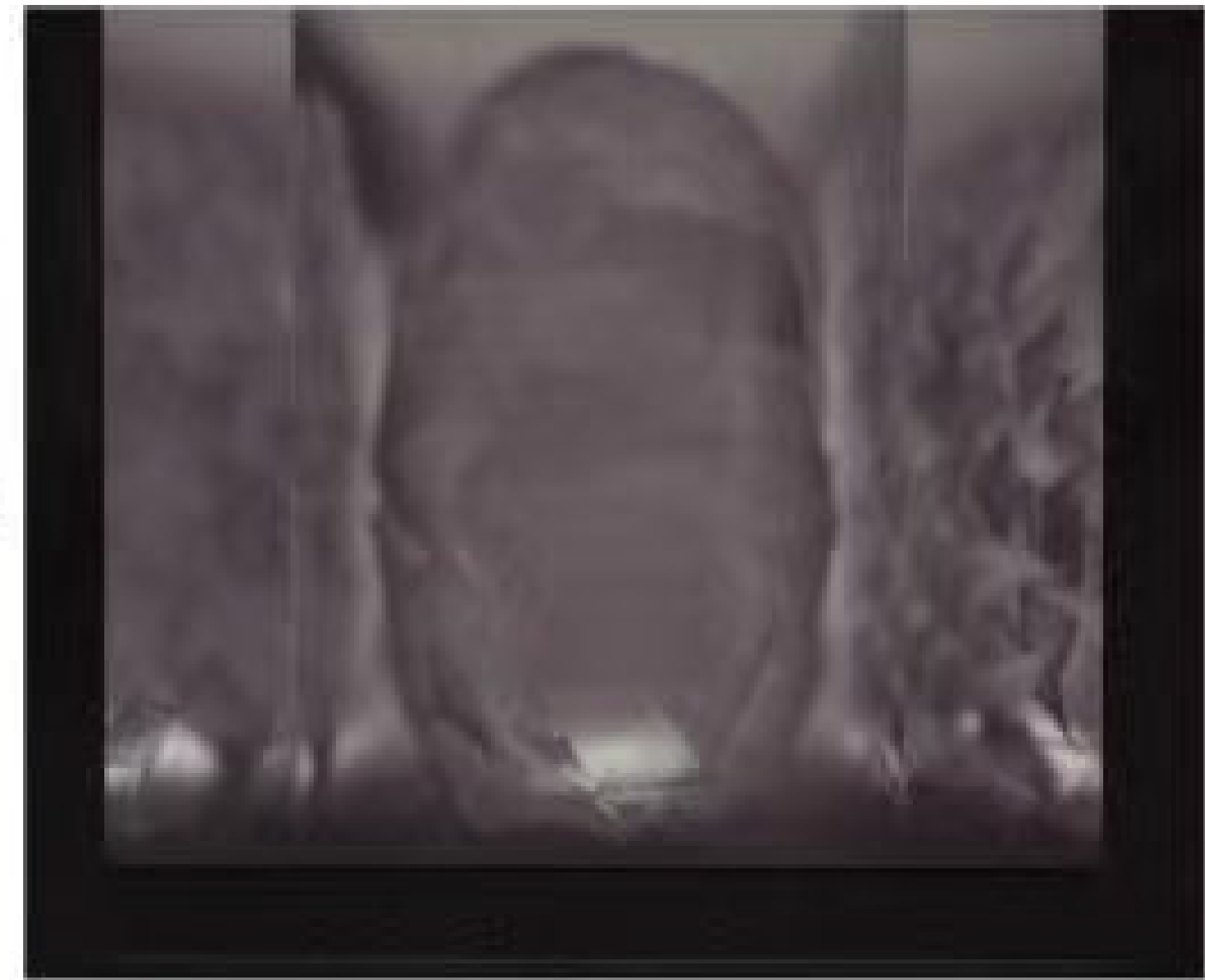

Installation

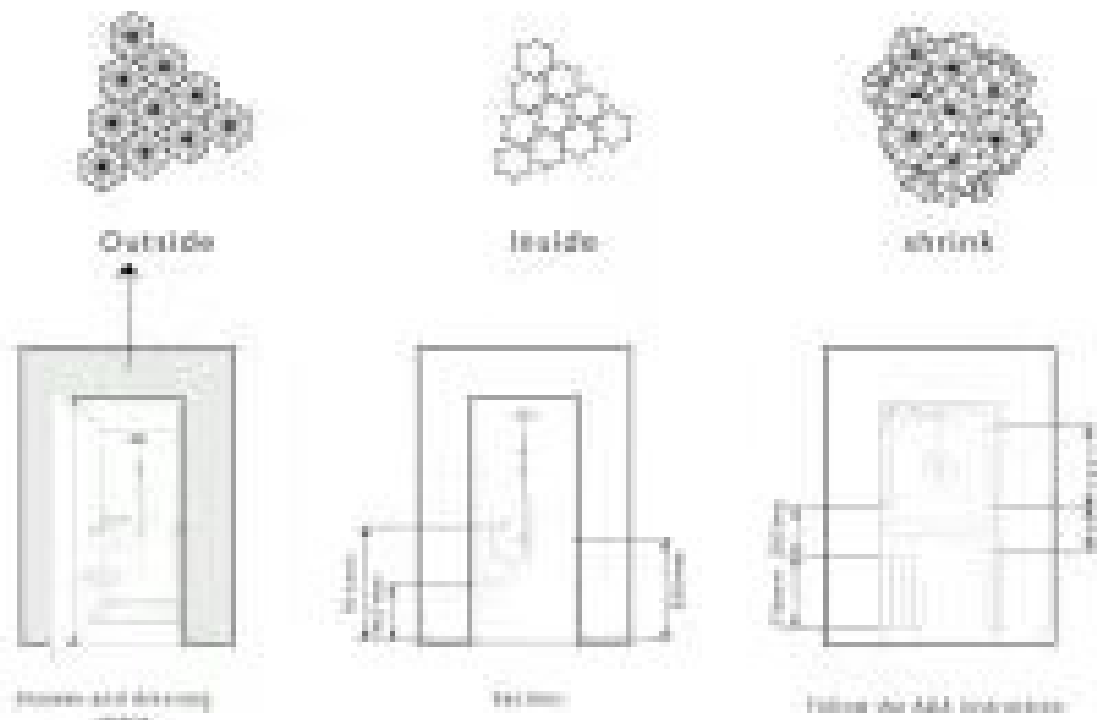

Other spots

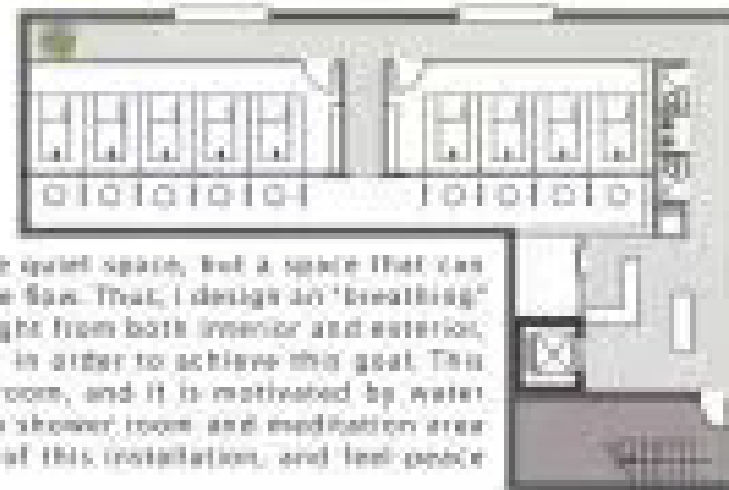

Meditation area is not a absolute quiet space, but a space that can help people be calm and feel time flow. That, I design an "breathing" installation and match up with light from both interior and exterior, as well as the feature of interior in order to achieve this goal. This installation wraps each shower room, and it is motivated by water used by customers. People in both shower room and meditation area are able to sense the movement of this installation, and feel peace and calm inside.

View of meditation area

Elevation





View of reception



View of corridor

INSIDE THE SHELL

A DESIGN OF JEWELRY STORE
LOCATION: HUANGPU, SHANGHAI

DESIGN BRIEF:

"Inside the Shell" is a jewelry store, in which I utilize many elements I find in shell, and I build this store into a "shell" which carries "pearl" inside. In my design, this store is not only a place with its exhibits, but a more interactive and vigorous space, in which customers could design their own jewelry and learn more information about shell protection.



Site analysis

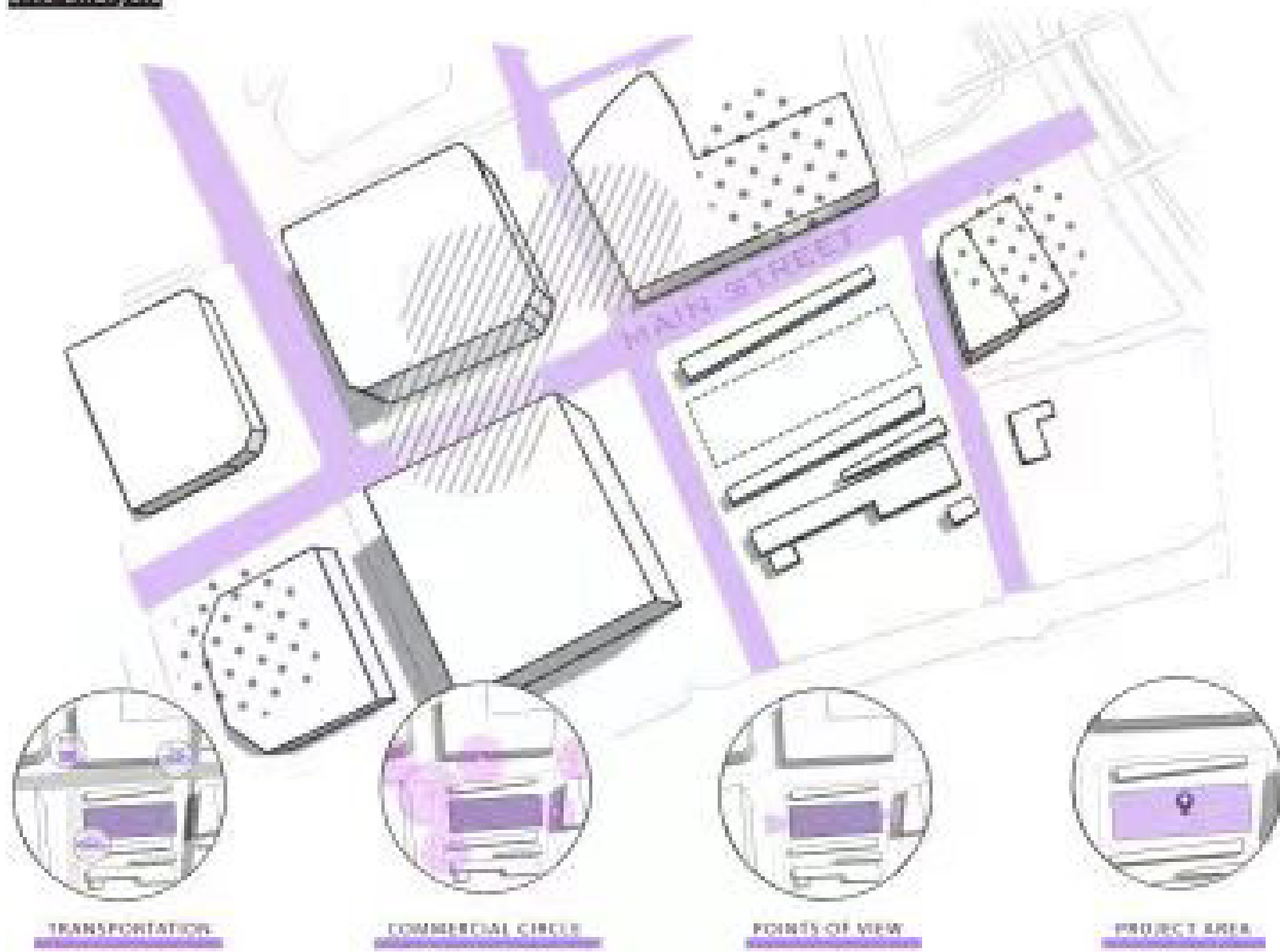

The store locates at the middle of business circle, and the transportation is very convenient, but it limits the view of store. Therefore, there is a huge shell-shape window on the ceiling to guarantee the natural light at day time.

- 10% Top and bottom floor
- 15% Hotel and Apartment
- 15% Company
- 15% Academy
- 15% Bank and shop
- 20% Restaurant and Bakery

Concept

The inspiration of this design comes from four elements of shell.



Processing diagram

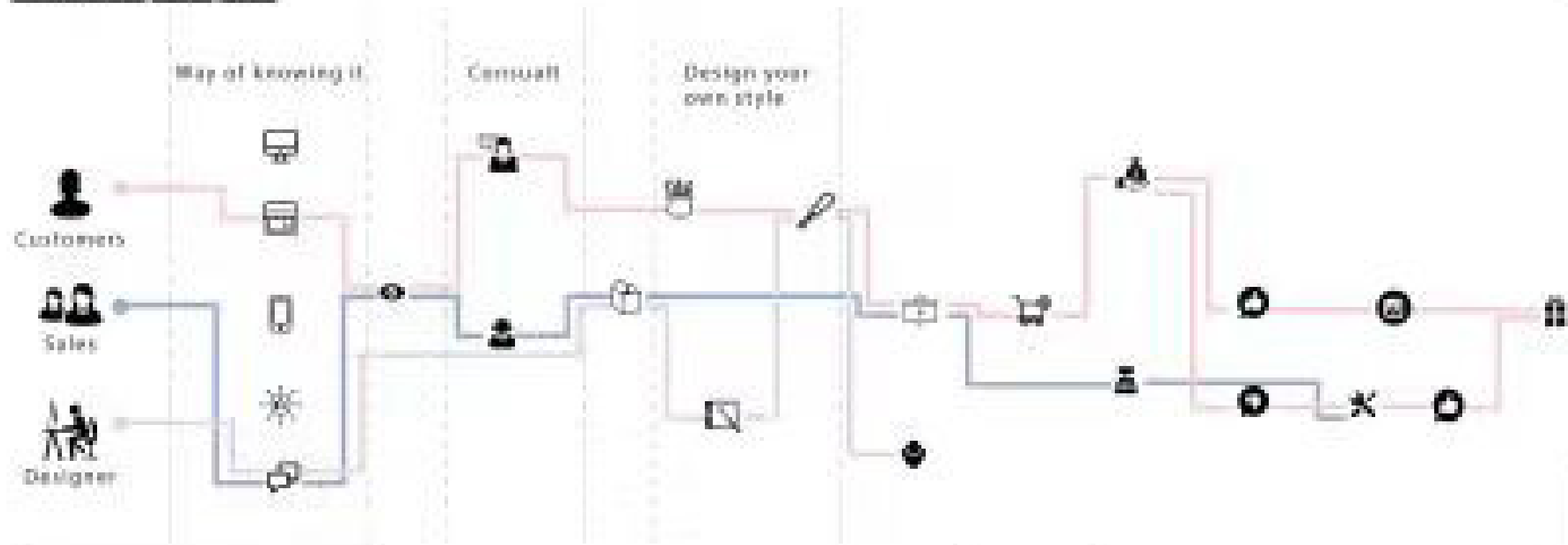

Exploded view

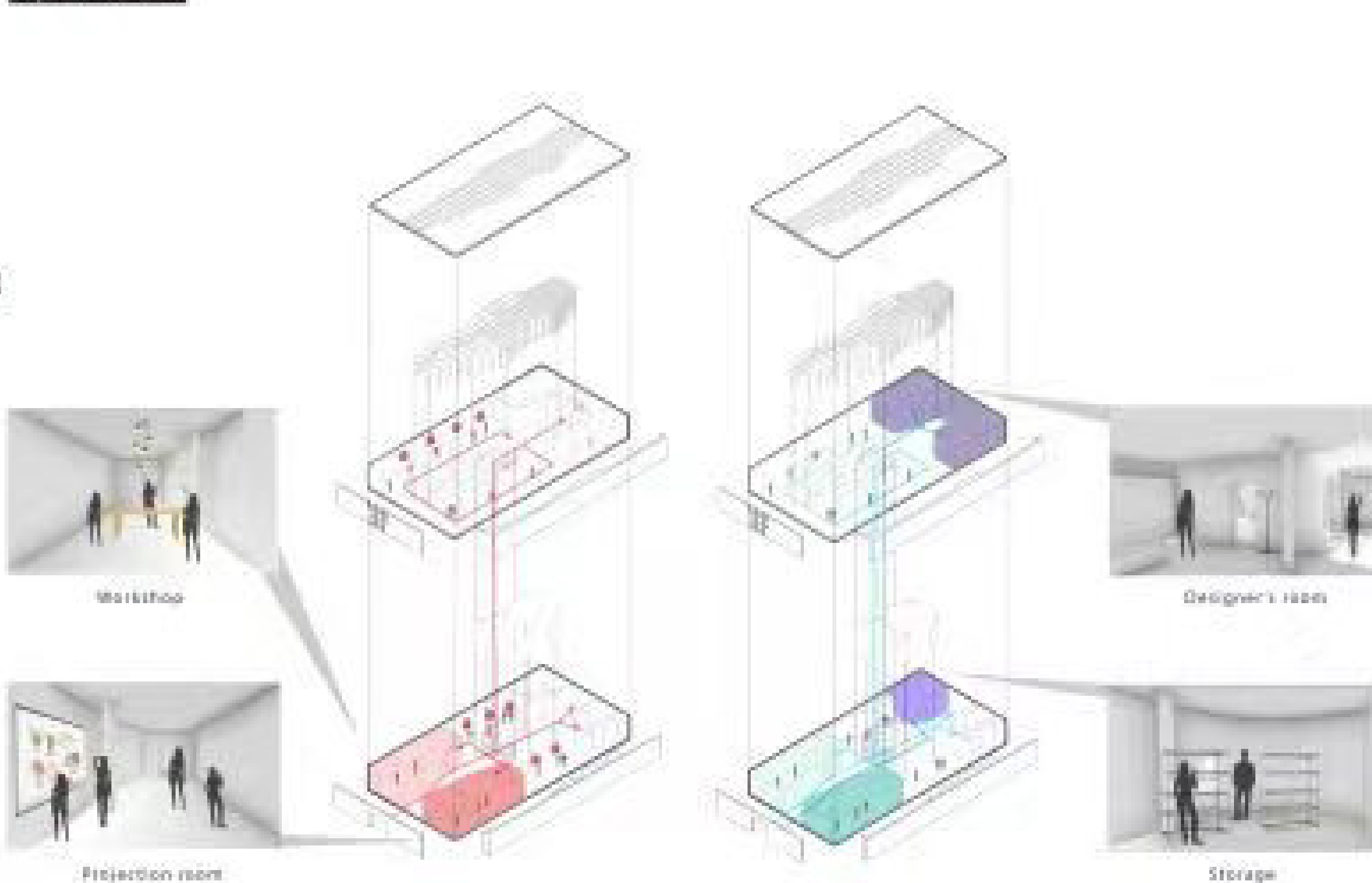

2nd floor display area texture

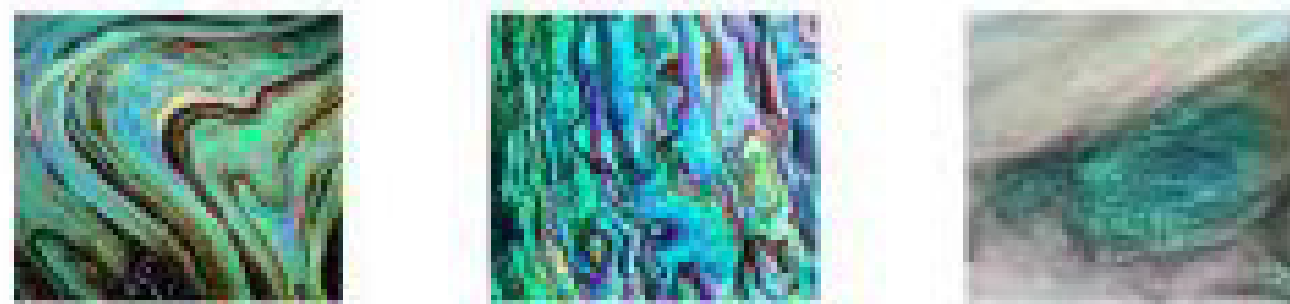

Furniture



These two exploded views are combined with two separate circulation. The one at left is for customers and the one on the right is for sales and designer. The denser the color is used, the more often the space is visited.

Plan

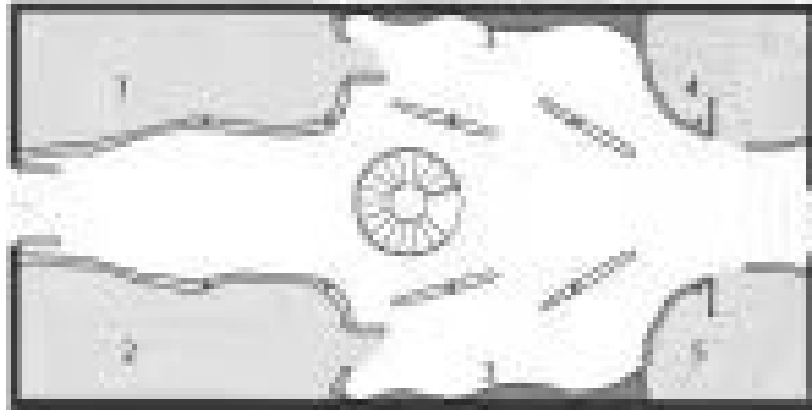

FIRST FLOOR

1.Workshop 2.Projection room 3.Exhibition area 4.Storage 5.Restroom 6.Projection area 7.Office 8.Studio

The four unparallel walls are set as such to block eye sight from the entrance and to create a different scenery from the reception to the outside.

Ventilation and sunlight:

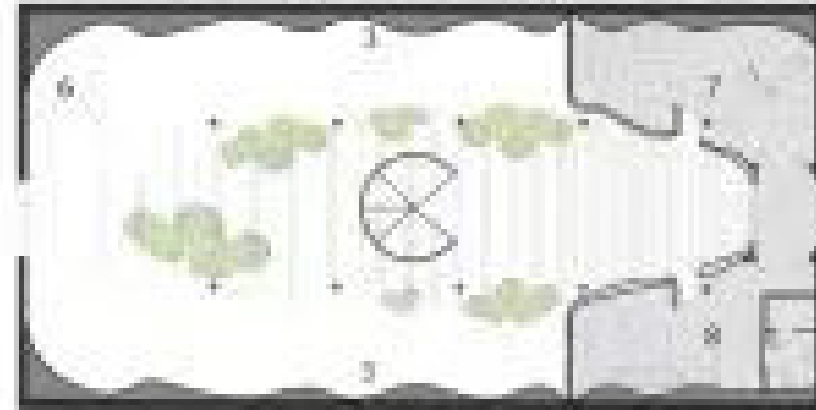

SECOND FLOOR

Second floor is divided into exhibition area and designer's office and studio. hanging sheet structure is arranged from sparse to dense for guiding the circulation and keeping privacy of designer's studio.

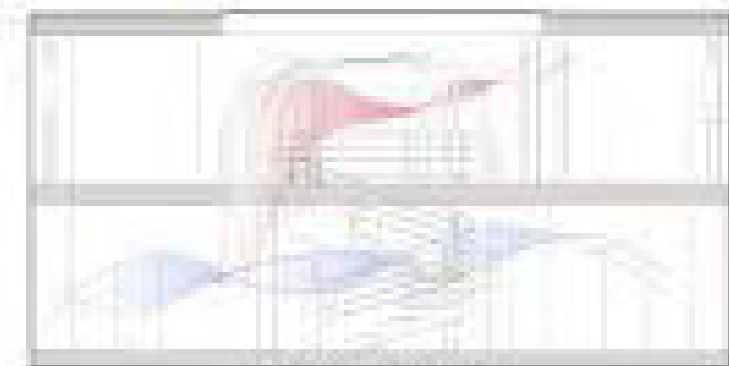

SECTION SUMMER

Summer noon sun
Sun light pass through glass
Ventilation and low heat transfer

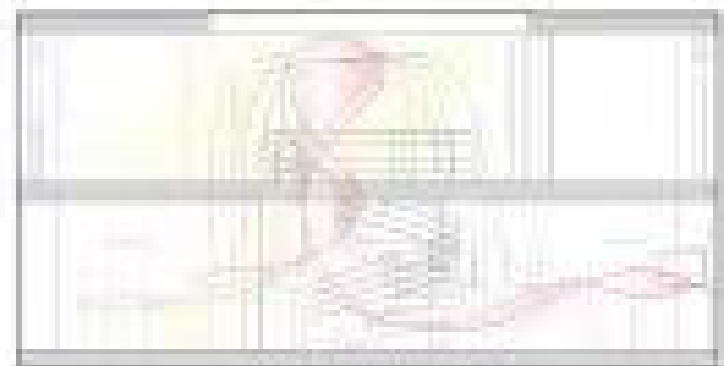

SECTION WINTER

Winter noon sun
Solar heat gain from large ceiling windows

Rendering



View of workshop



View of first floor



View of second floor



View of second floor

FLOATING BUBBLE

A DESIGN OF VEGETABLE MARKET

DESIGN BRIEF:

"Floating Bubble" is a future market, the opposite of the current existing markets, which is clean, bright and lightsoam. The shape of market can be modified to accommodate different environment. In urban area, it is a vegetable market, while in suburb, it is a greenhouse.



Inspiration

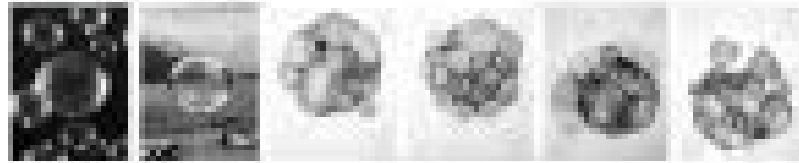

1. Corridor
2. Sales area
3. gathering area

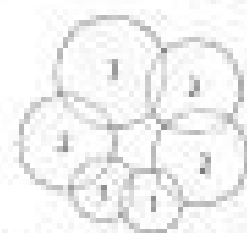

No corridor connect sales area and gathering Area

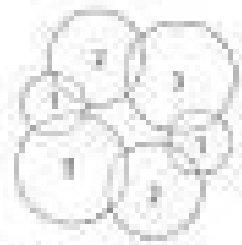

More than one gathering area distract circulation

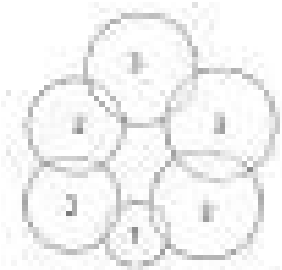

Too much gathering area Not enough sales area

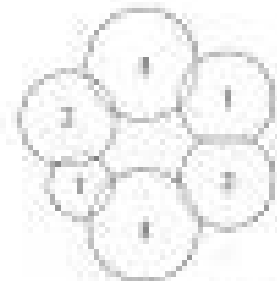

More than one gathering area distract circulation

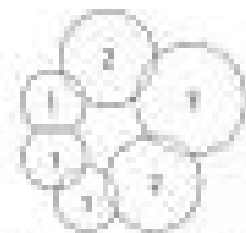

Too many unnecessary corridors

Shading Material



Without shading



Shading off



Shading on

High albedo material on the surface reflect heat from absorbing into interior

Material of flooring



Solid material looks heavy

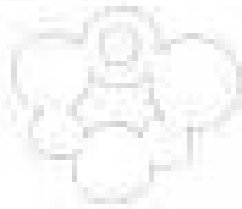

Bright material looks lighter

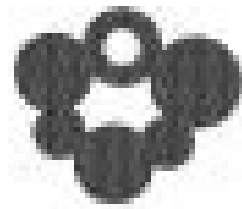

perforated material conduct to ventilation

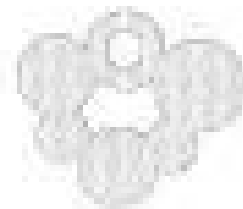

Bright perforated material is lighter

Shape matches up the location

The organization can be modified to different locations

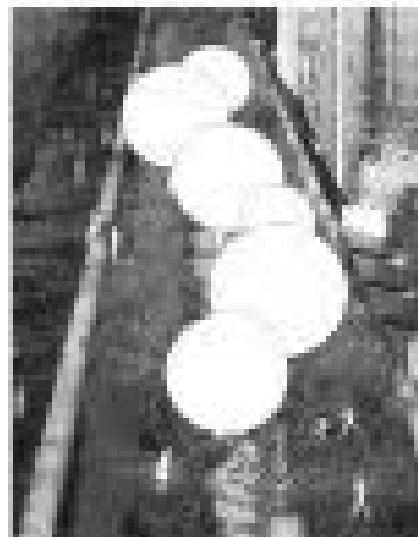

Elevation



Plan



Plate distribution

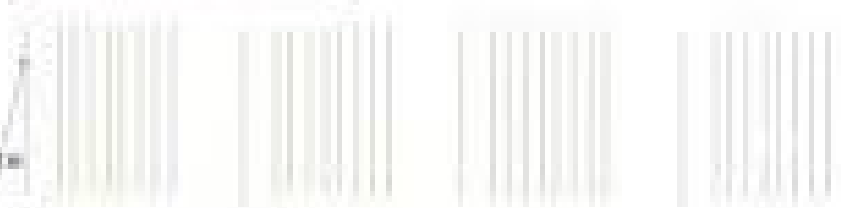

Stand material

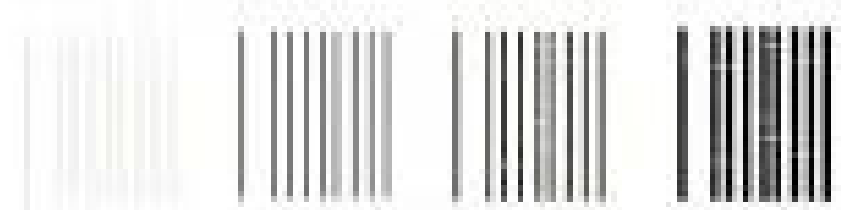

Floating effect at daytime

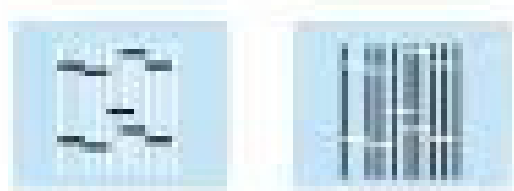

Floating effect at night

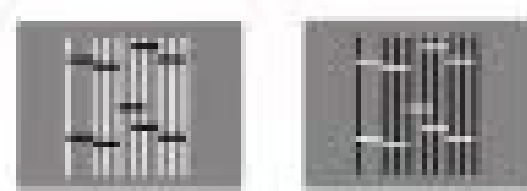

Exploded view

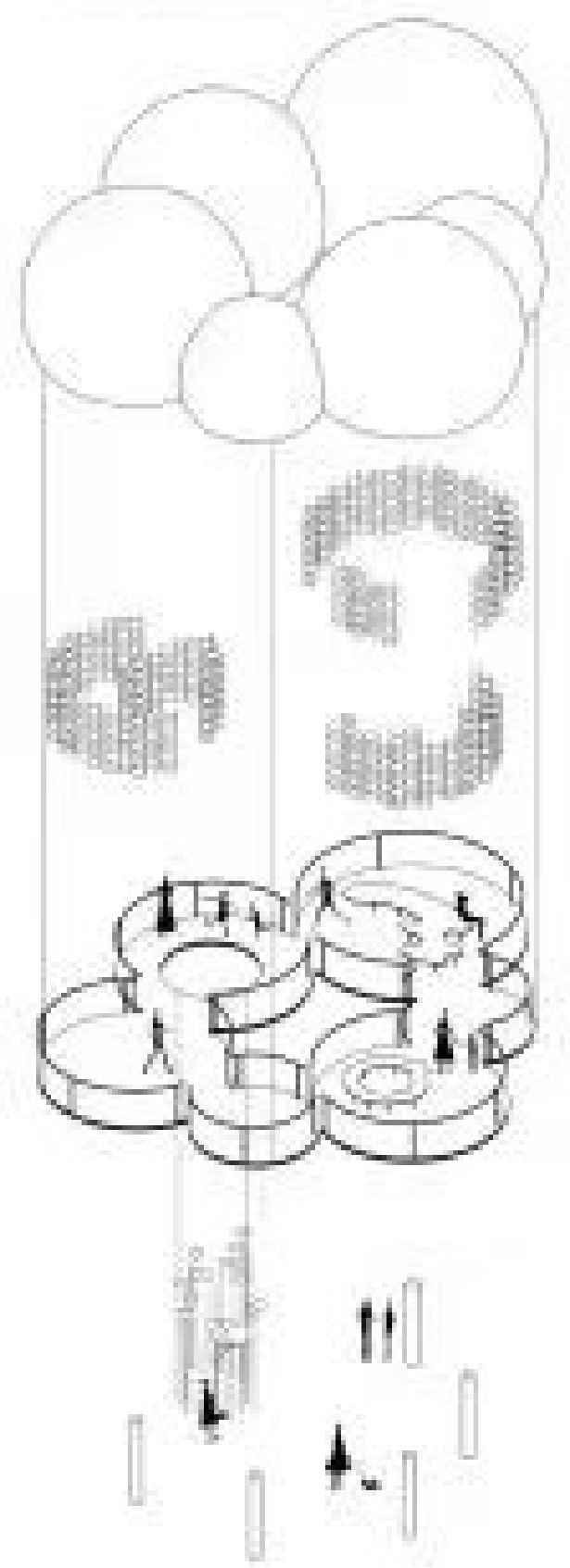

Exterior of vegetable market



Interior of waiting area

Model



Close view



Overall view



Close view



Top view

PAWS AT NEXT DOOR

A DESIGN OF DOG HOTEL
LOCATION: PUTUO, SHANGHAI
(DESIGN BRIEF)

"Mini District" is a dog hotel which includes a gymnasium and a studio that dogs and owners could exercise together. The original intention of this design is to change the current situation of dog hotels in China and to prolong the company time with dogs.



Program

Time spent at home at different age

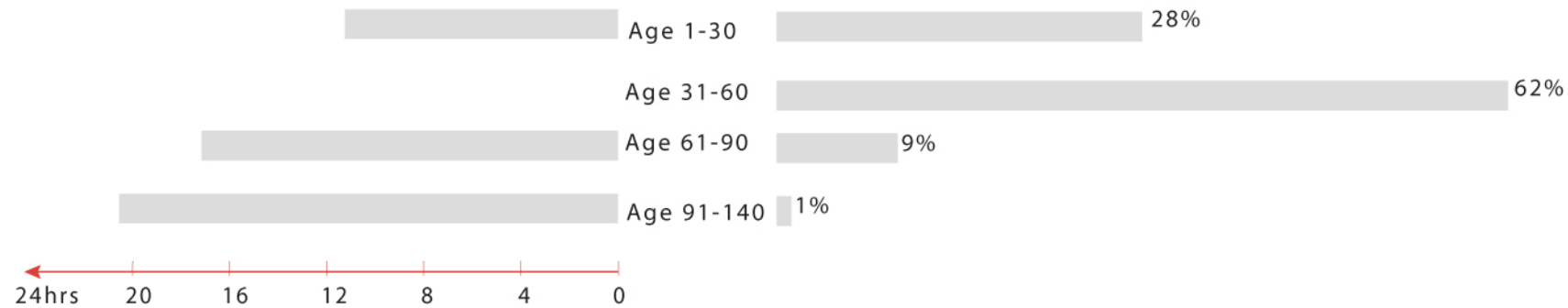

Dogs need at least two hours with their owner everyday. To prolong the time with dogs, this space effectively combine pet-owners' exercise time with dog-walking time.

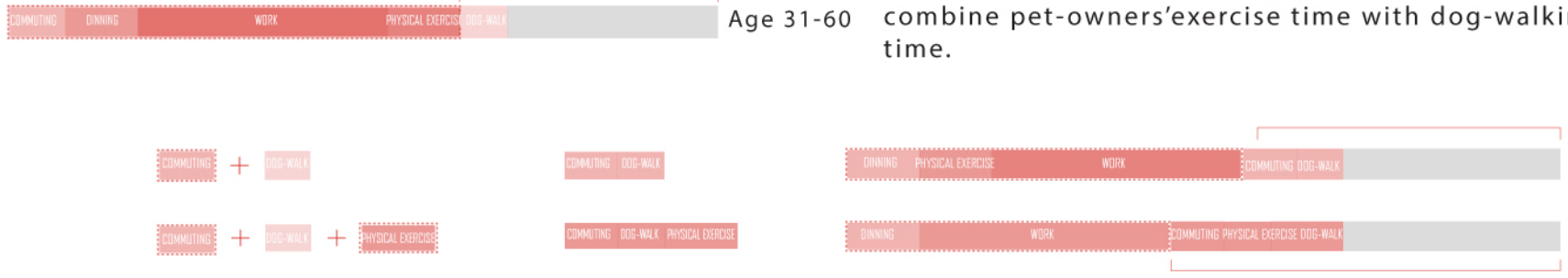

Exploded view

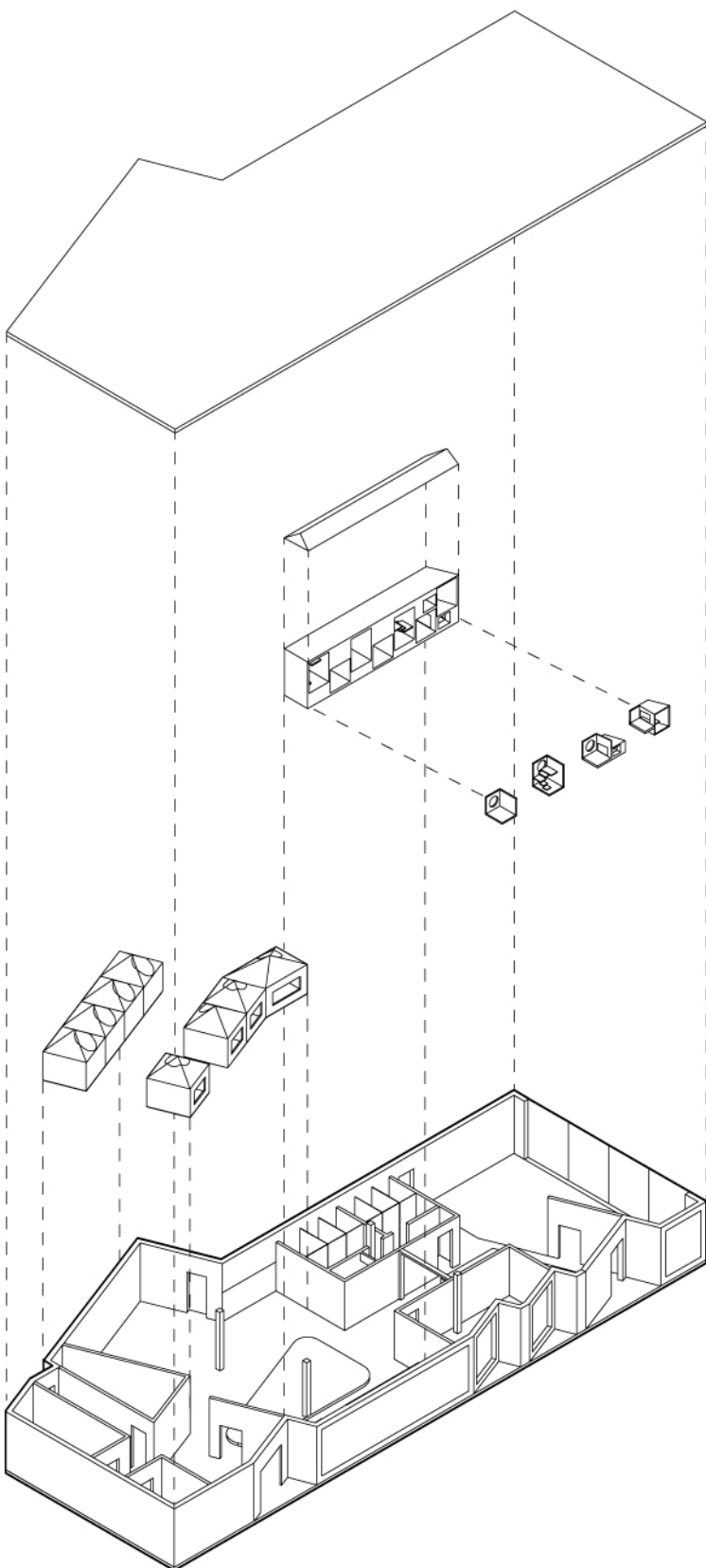

Plan

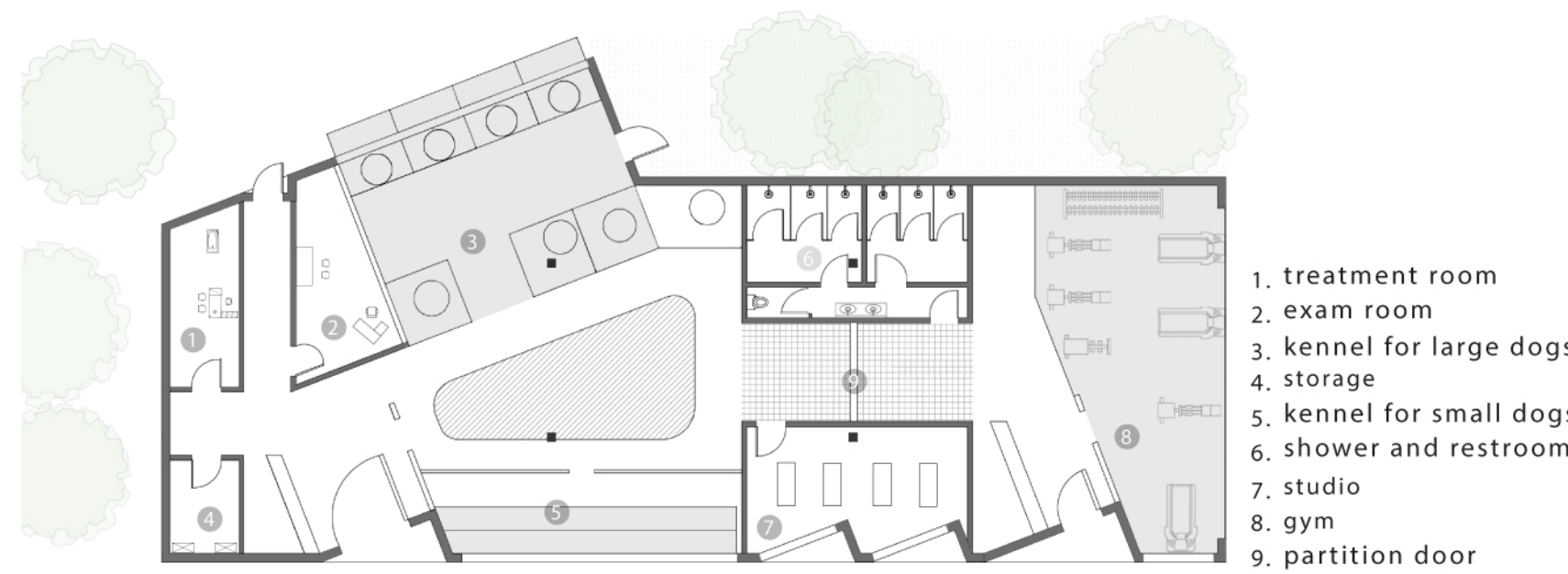

The studio, located at the middle of architecture, is not only the transition between different functions but also the transition of quietness and noise.

Processing diagram

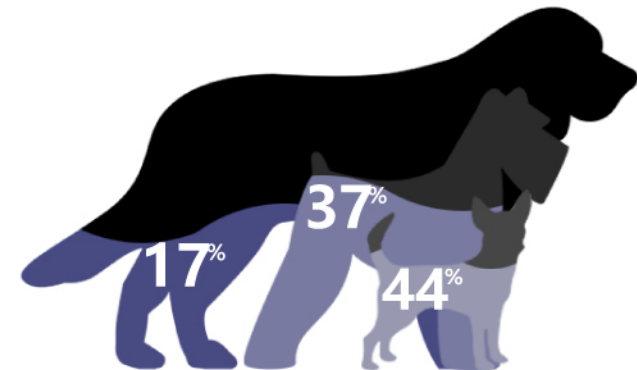
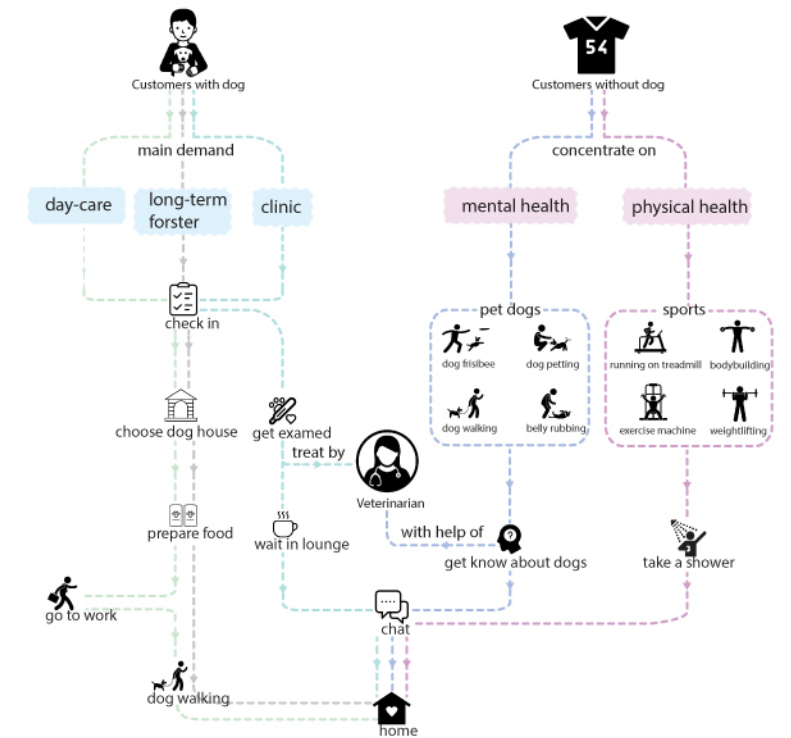

43	17	22
62	78	39
112	41	69

Function diagram

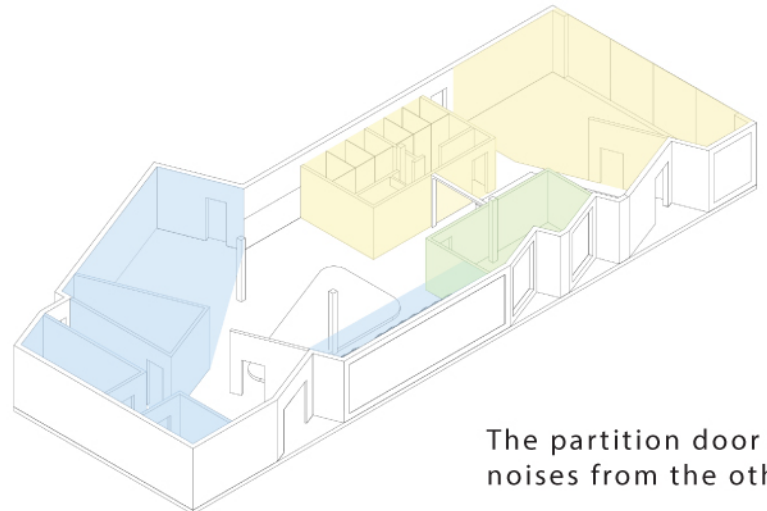

Voice analysis

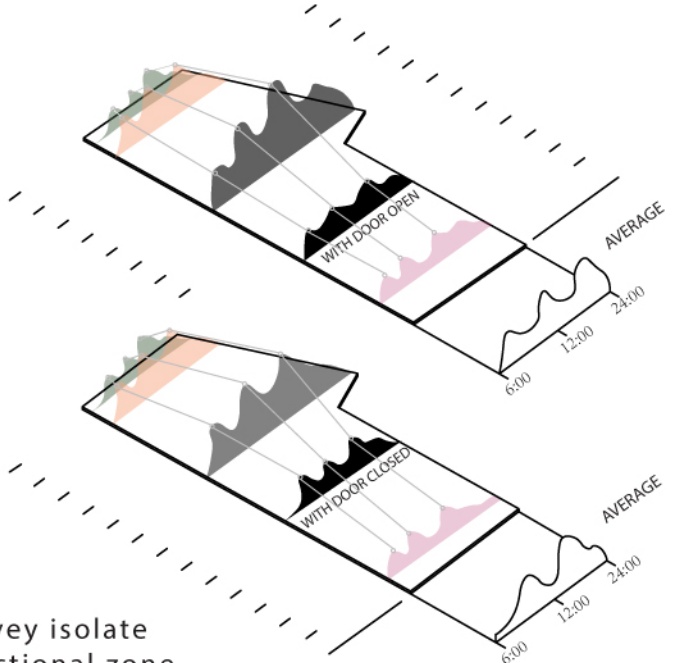

The partition door effectively isolate noises from the other functional zone

Concept



Nowadays, increasing people decide to keep pets as their emotional sustenance, however, Modern life usually equals to longer work time and less casual time. It results in less time with pets. In order to change this situation, I design this space with an idea of a "small district" which combines the dog hotel and gymnasium.

Meanwhile, I find out there are many disadvantages of traditional pet hotels. For example, in some traditional pet hotels, giant breeds and small breeds are kept together, dogs with different character are kept together. These all could lead to conflicts between dogs and may cause danger. I believe what dogs really need is a clean and comfortable place that they can exercise with their owners as they want and run in the open air every day.

Site analysis



Nearby business and shops

Dog density

Dog-walking routes

Material



Elevation

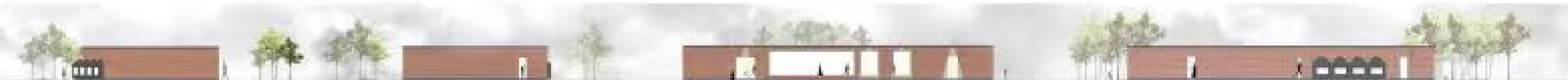

Ventilation



SECTION SUMMER

Summer noon sun
Sun light goes through glass
Ventilation and low heat transfer

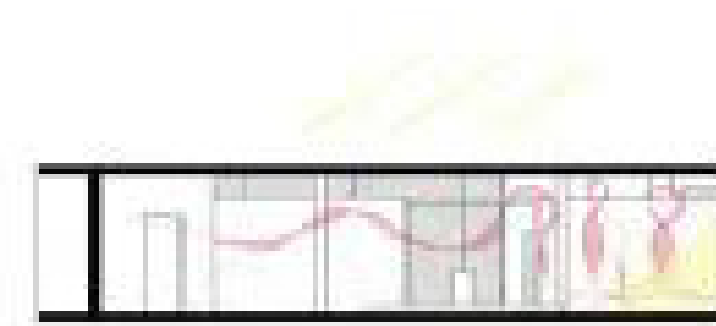

SECTION WINTER

Winter noon sun
Sola heat gain from large southern windows



- 1. Brick
- 2. Wood
- 3. Concrete
- 4. Concrete
- 5. Paint
- 6. Grid

Material of gym

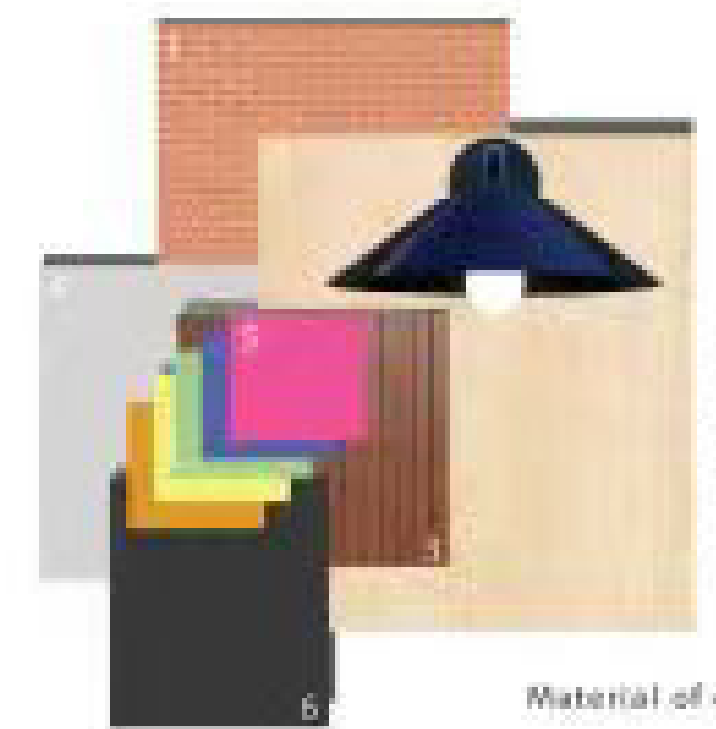

- 1. Brick
- 2. Wood
- 3. Tile
- 4. Paint
- 5. Paint
- 6. Blackboard paint

Material of dog hotel

Rendering



View of exterior



View of kennel



View of dog hotel

Printmaking



Etching



Etching



Etching



Drypoint

Collage and photography



Collage



Collage



Photography



Photography