

How Neighborhood Groups Are Stepping In Where the Government Didn't

Mutual aid groups, which have provided a crucial pandemic safety net, are evolving into a long-term effort to help with food, clothing and counseling. “It’s about building the world we want to see,” a volunteer said.

By [Kimiko de Freytas-Tamura](#)



Desiree Joy Frias made ham and potato soup in her Bronx home, part of a volunteer effort to fill community refrigerators. Credit...Anna Watts for The New York Times



The refrigerators stocked by volunteers like Yves Voltaire, left, and Galadu Subah have helped feed people in need during the pandemic. Credit...Anna Watts for The New York Times



Laura Alvarez, a graffiti artist with BX Arts Factory, painted a community refrigerator set up in the Kingsbridge neighborhood in the Bronx. Credit...Anna Watts for The New York Times

Community Space

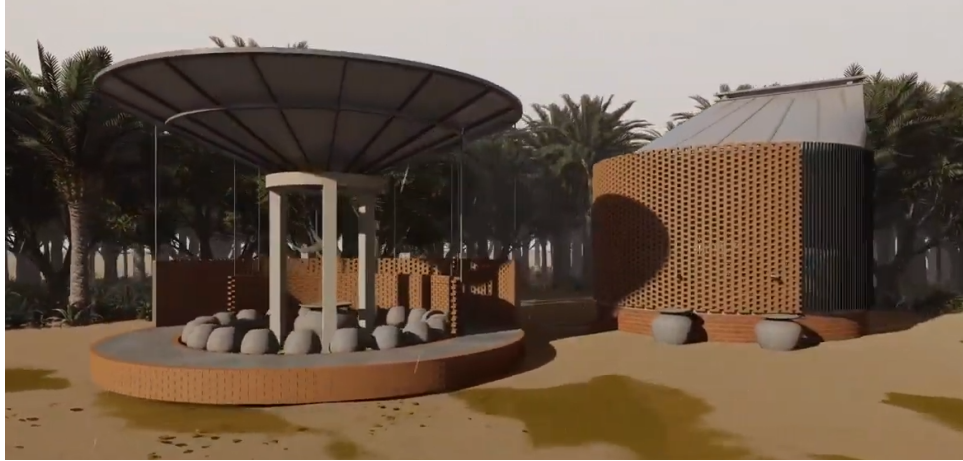
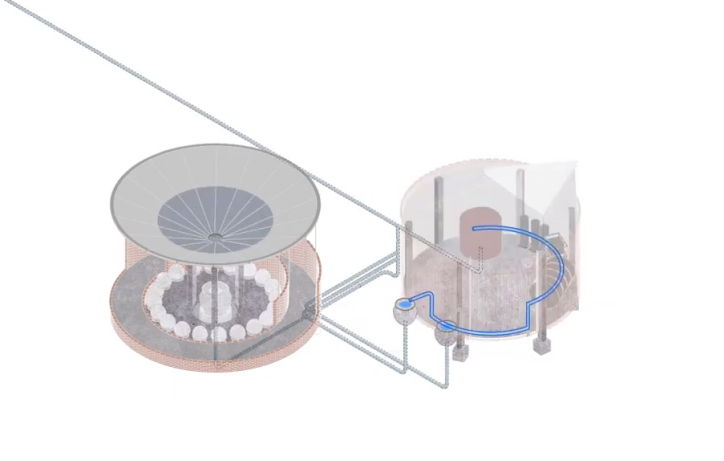

[Orient Occident Atelier builds community hall in Cambodia that harvests clean drinking water](#)



Unparelld'arquitectes has built an arched public shelter in Spain, intended to **be used as a performance backdrop to encourage activity on the street**. The studio used the four buttresses that support a party wall to replace a house that was demolished to improve the area's street alignment. A construction of three vaults and four niches is offered to the public space as a porous facade, accompanied by a minimum of stands. It is an unfinished and appropriable structure, a scenographic support for urban life.



Unparelld'arquitectes , Emergency Scenery public performance backdrop, Olot, Spain

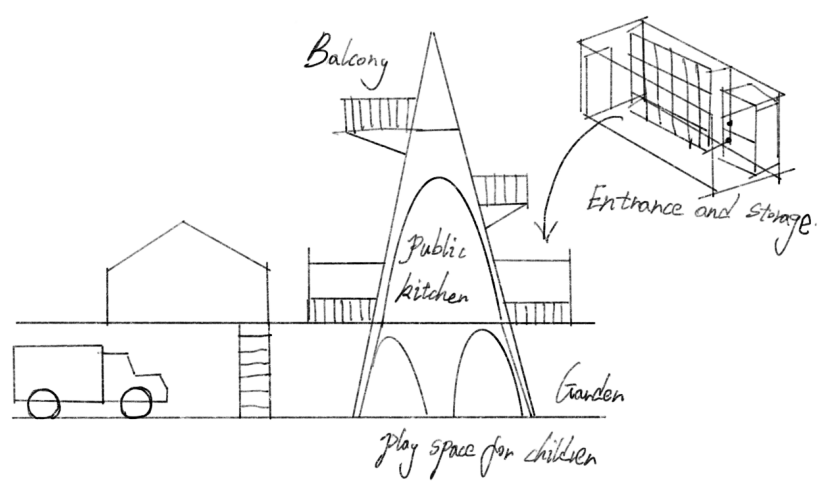
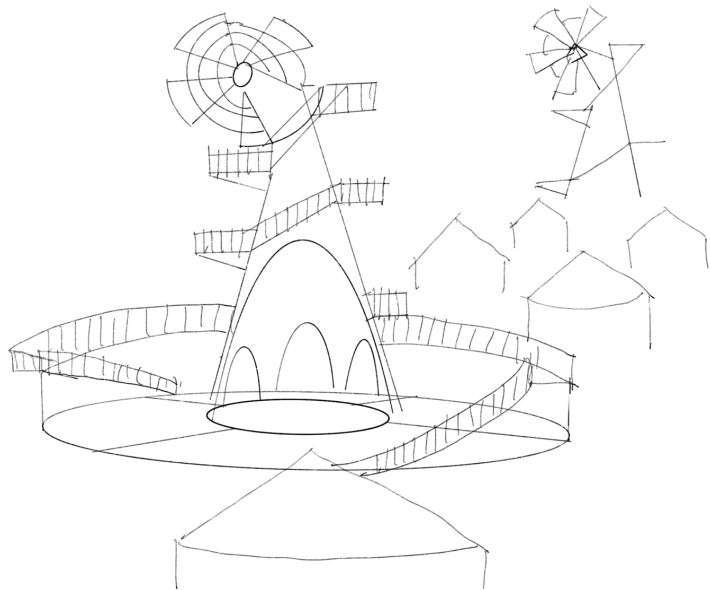

SSLITE SERIES



Affordable, quick to set up and easy to maneuver with minimal resources on site, the SSLITE Serie is definitely the future of pop-up tents. Their lightweight and modular design offers a great range of customization and upgrades. You also have the possibility to transport them yourselves, without Steel Space Concepts' assistance, using a pick-up or a SUV!

ACTIVATION READY SERIES



Our activation ready series will give you the advantage of a quick strike or guerilla campaign in a pre-designed, turnkey solution. All these models have additional options such as a rooftop terrace, railings, staircase, branding and furniture. Generate attention with these attractive modified shipping containers.

CUSTOM MADE UNITS

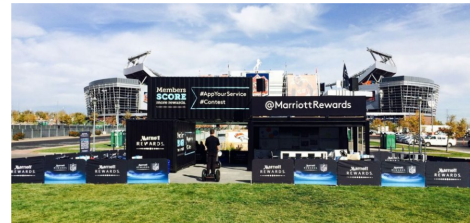

A living space, a mobile restaurant, an industrial structure or even a multiple containers layout: each and every project requires a special and unique design. Thanks to our Steel Space Design Studio engineers, welders and technicians, we can make any shipping containers modifications to build new exciting concepts into a unique and highly modified structure.

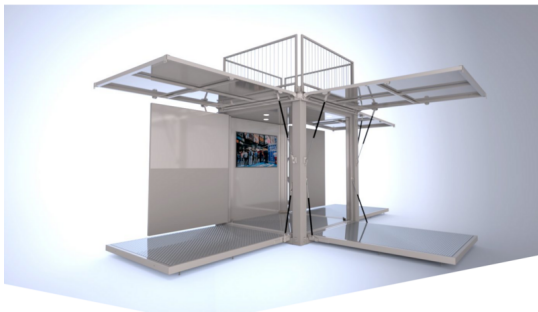

Large Container — 16-Foot



The Perfect Size for Bigger Households

- Perfect for a 1,200 sq. ft. space* or smaller
- Great for moves requiring temporary storage
- Our largest size, and a popular choice for moving a home with 3 to 4 rooms
- Comparable to a 10'x15' storage unit or a 20' rental truck
- Imagine a parking space in 3D
- Weight limit: 4,200 lbs.
- 835 cubic ft.
- Dimensions: 16' x 8' x 8''

Watch our What Fits in a 16-Foot Container video. Try our [Moving and Storage Calculator](#) to determine which size and how many you need.

[Get 16-foot container pricing](#)

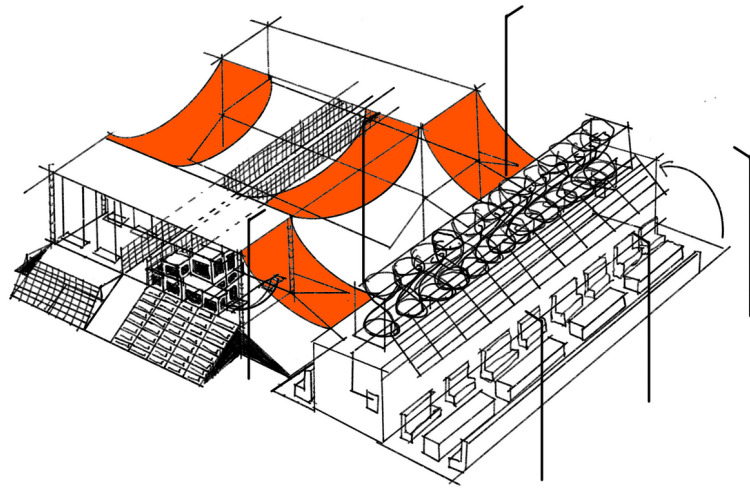
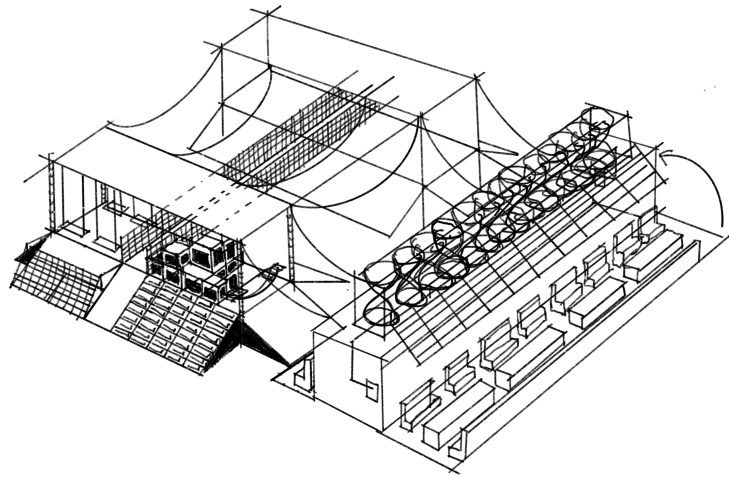

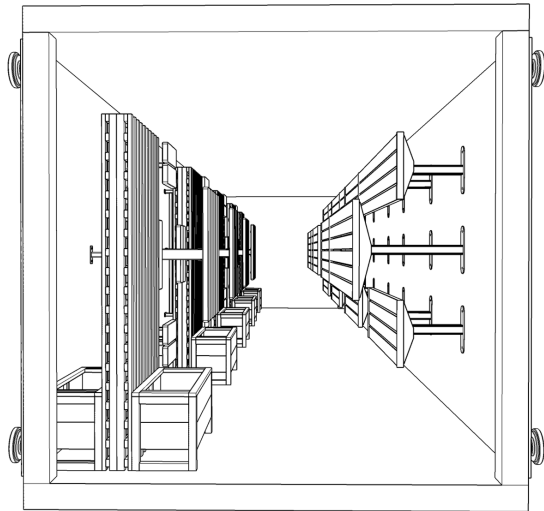
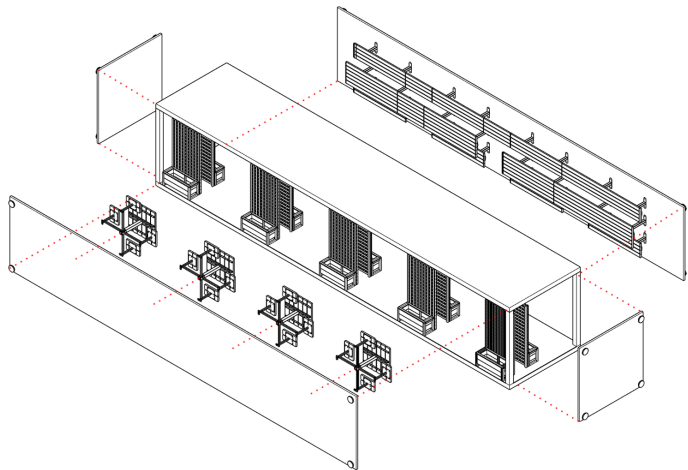

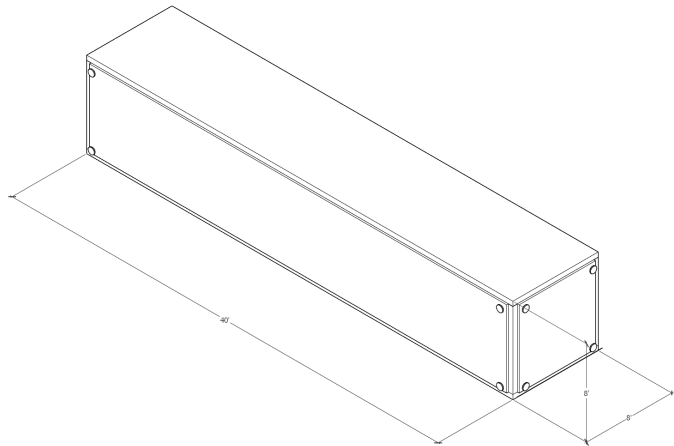

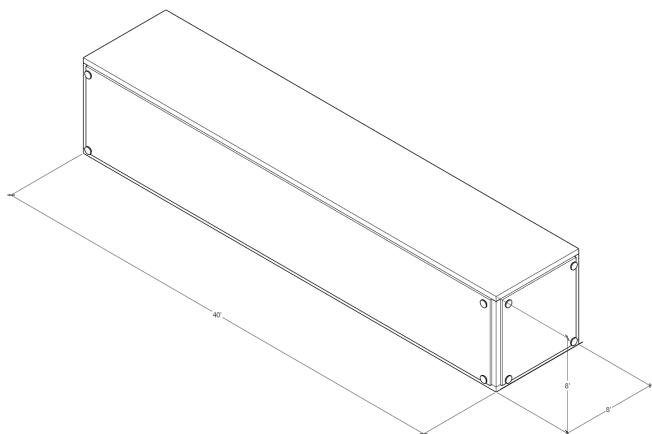
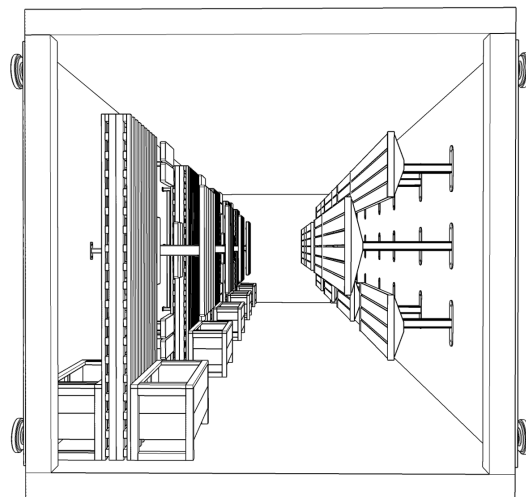
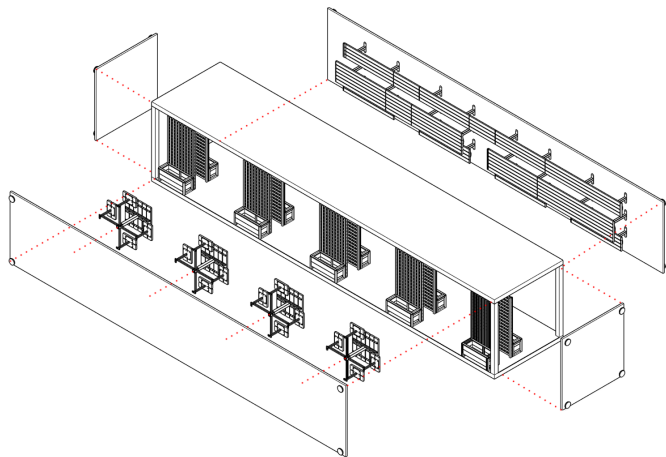



Danish design collective [Superflex](#) has filled the [Tate Modern's](#) Turbine Hall with a snaking framework of three-seater [swings](#), which it hopes will encourage social interaction between visitors.



London designer [Philippe Malouin](#) has used quartz surface material Caesarstone to form the seats of twelve [swings](#) arranged in a circle for an exhibition later this month.

