



**KELLI MCGRATH**

**Interior Design Portfolio**

**2019-2021**



1

01-08

THE TOOL SHED



2

09-12

A...CHAIR?!

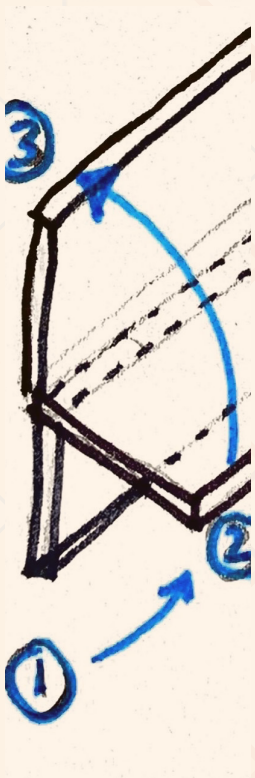

4 ORIGIN



3

13-20

MEANDERING  
PATHS

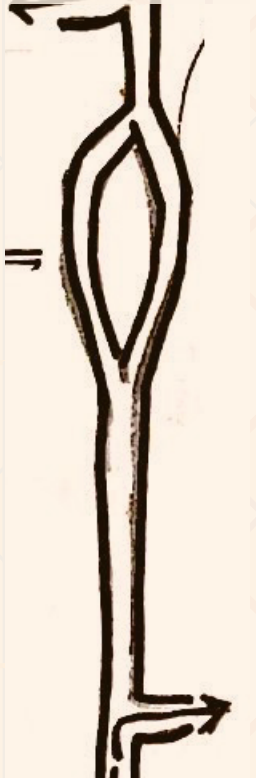

4

21-26

THE TREE HOUSE



ad  
alls /me



5

27-34

FARM TO TABLE



DINING

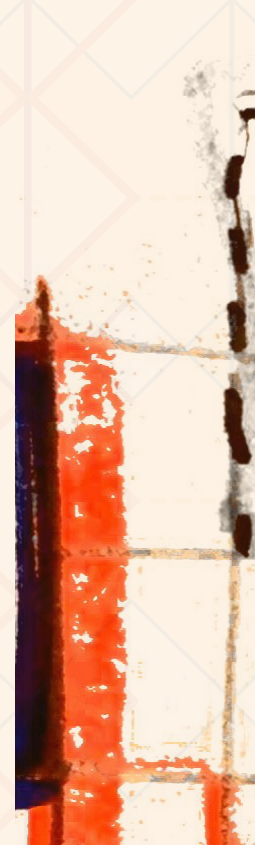

6

35-42

THE CARVED  
DWELLING

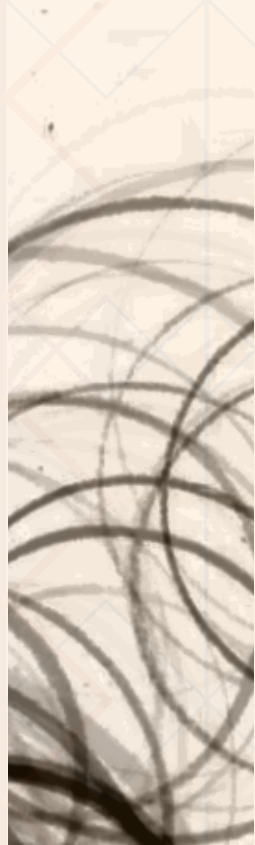

7

43-50

THE THINKING  
HAND





# THE TOOL SHED

**TYPE:** Community Center

**SITE:** Stanton Building, Sara D. Roosevelt (SDR) Park in the Lower East Side of Manhattan

**BRIEF:** The Stanton Building has been closed to the public since the 1970s. Working directly with the community and actual programming studies by community groups, the two-story NYC parks building is to be re-imagined as well as its surrounding context to reactivate the area and bring the community together.

**CONCEPT:** The Stanton Building is transformed into a **TOOL SHED** as a place to share resources, advice, and knowledge. The sharing of resources, materials and tools allows for serendipitous encounters with the other community members.

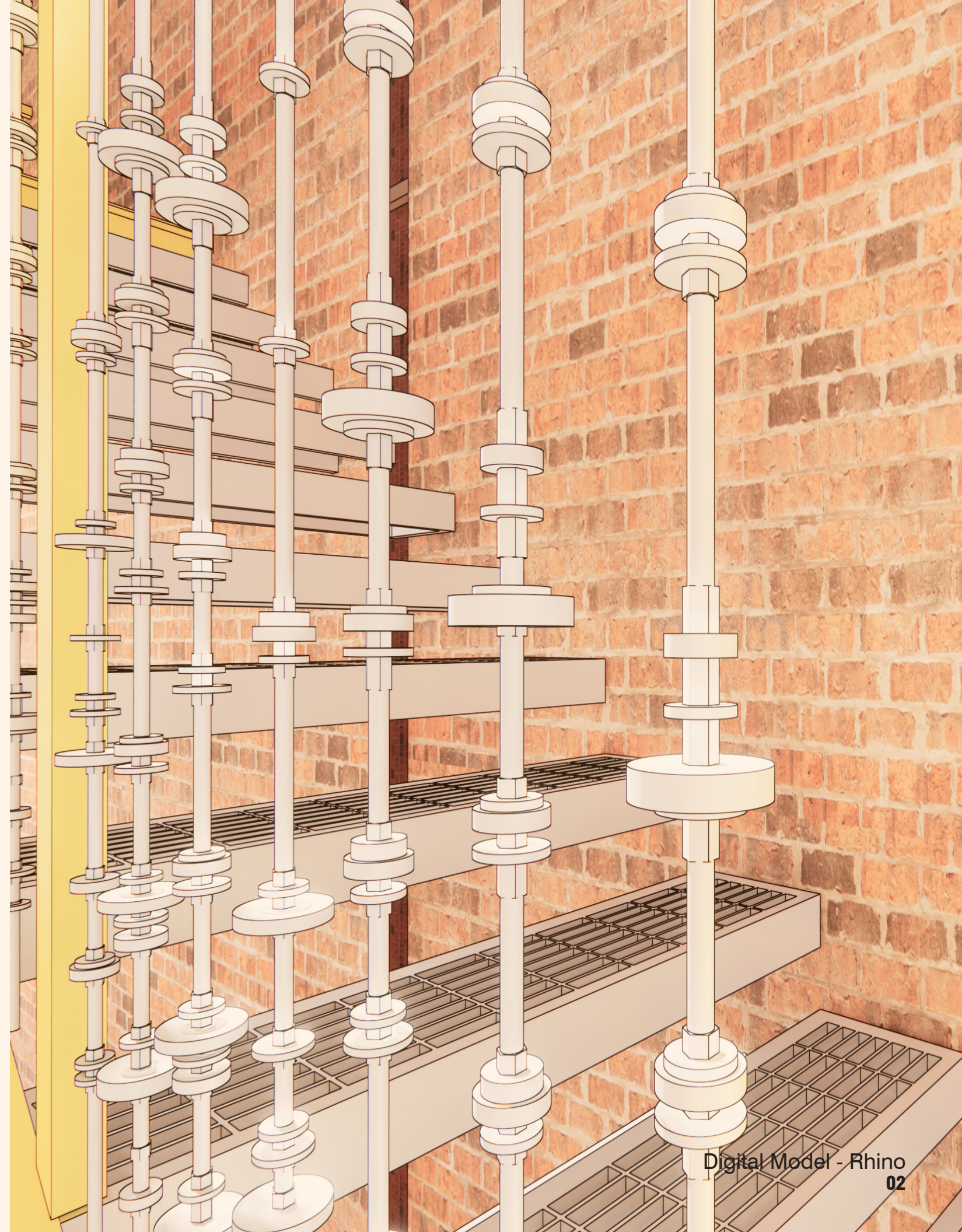



# CREATIVE-REUSE MATERIALS



Wood Pallets on ceiling - Donated by local construction material store.

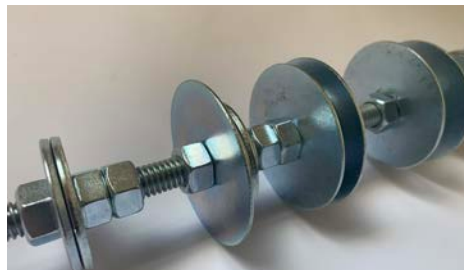

Donated / found washers and nuts for guardrail posts along the stairs



Wood surfaces made from old cabinet doors donated by the community.

# COMMUNITY ENGAGEMENT

The Stanton Building can be a place for **skill-sharing and knowledge-building workshops** for the community. The members can participate in the making process of taking found materials and reusing them throughout the site. An example would be to reuse found washers and bolts for the guardrail post design.

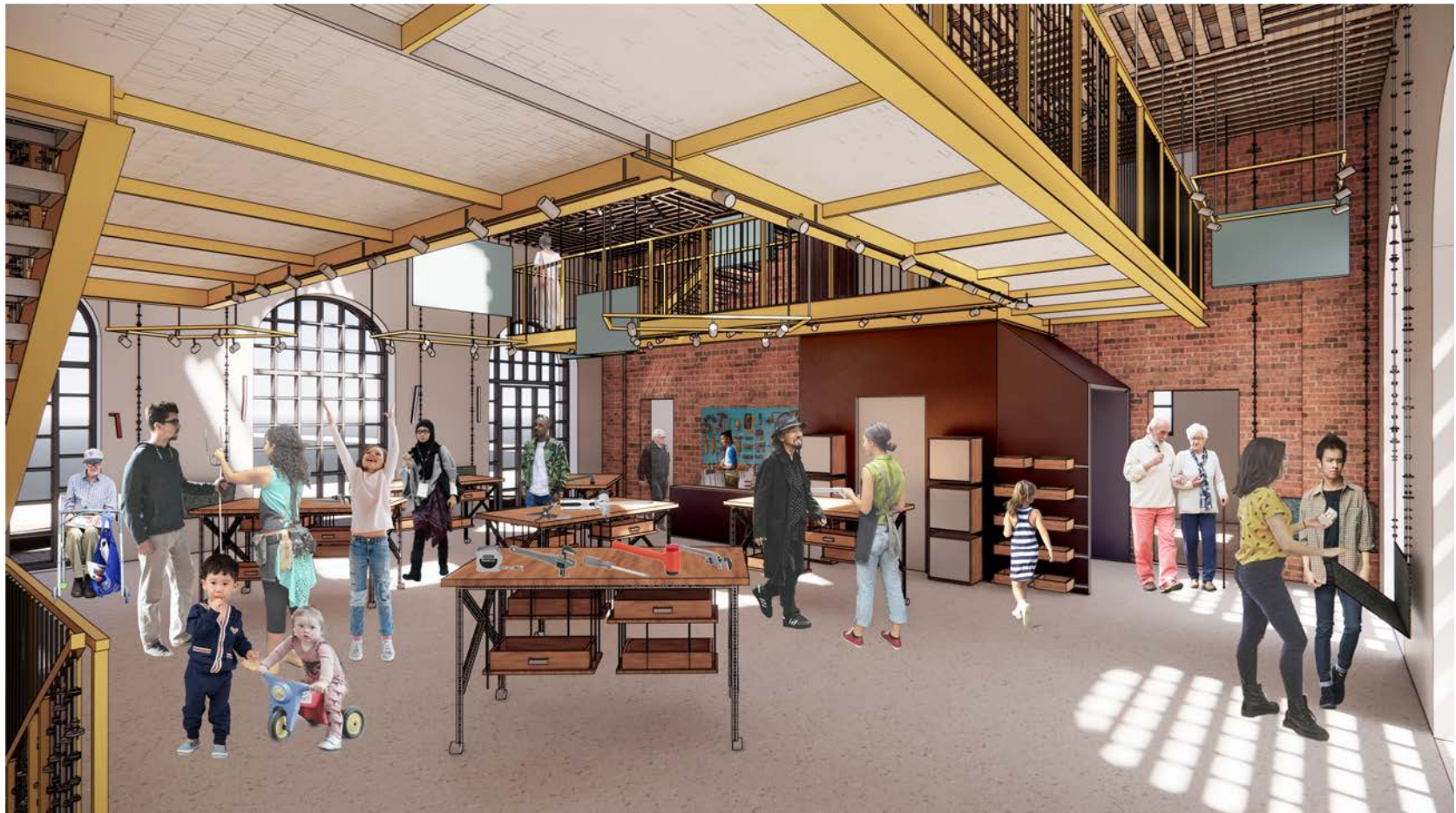

# FLEXIBLE CENTRAL SPACE

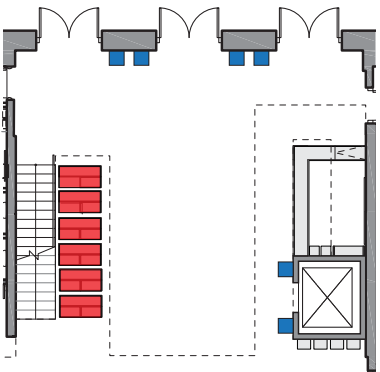

Large gathering, performance

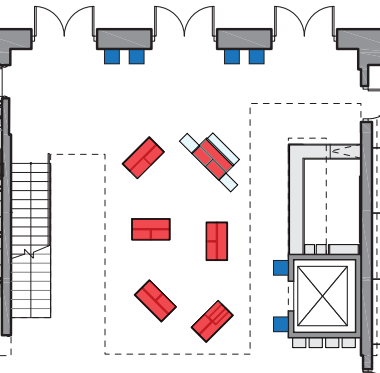

Tool Library Display

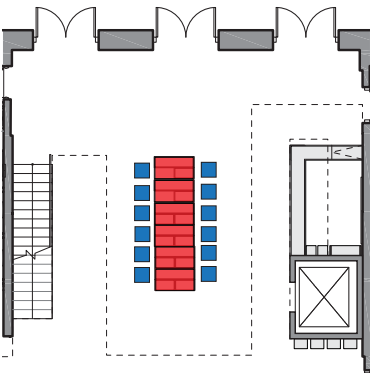

Community Meeting



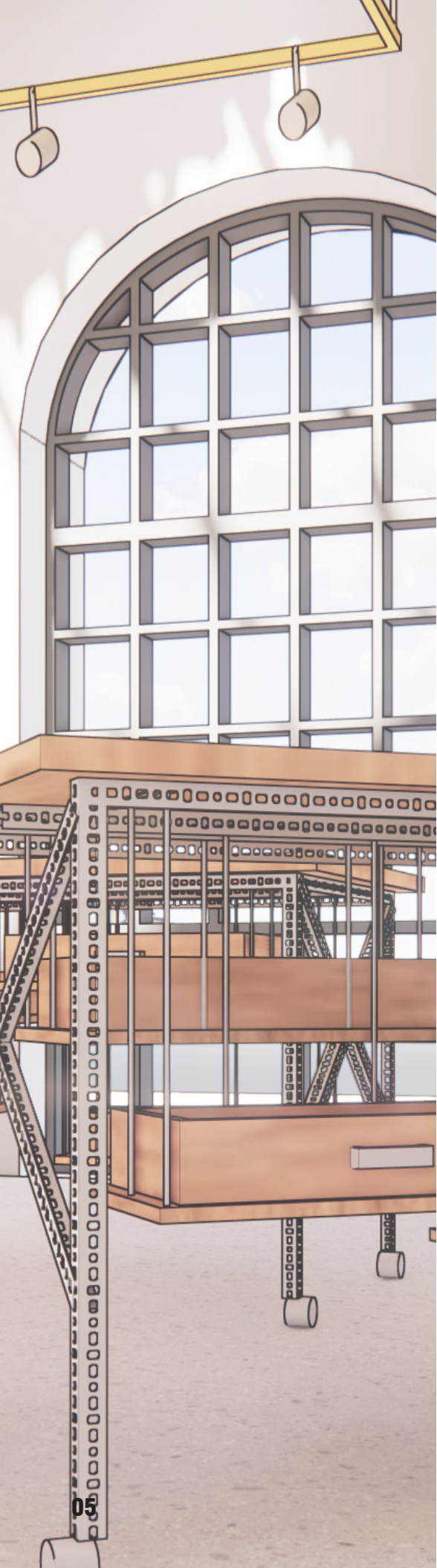

## TOOL BENCH

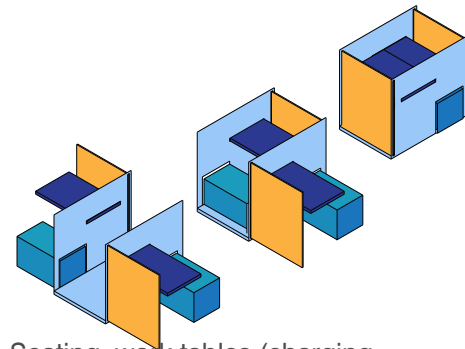

Seating, work tables (charging Stations embedded in some)

## RECREATION BOX

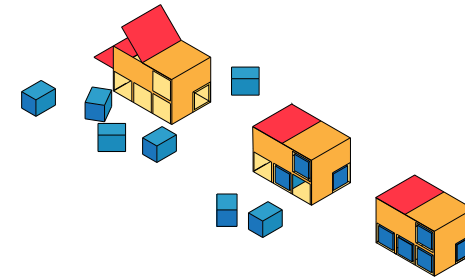

Games, toys, yoga mats, weights, jump-rope, etc.

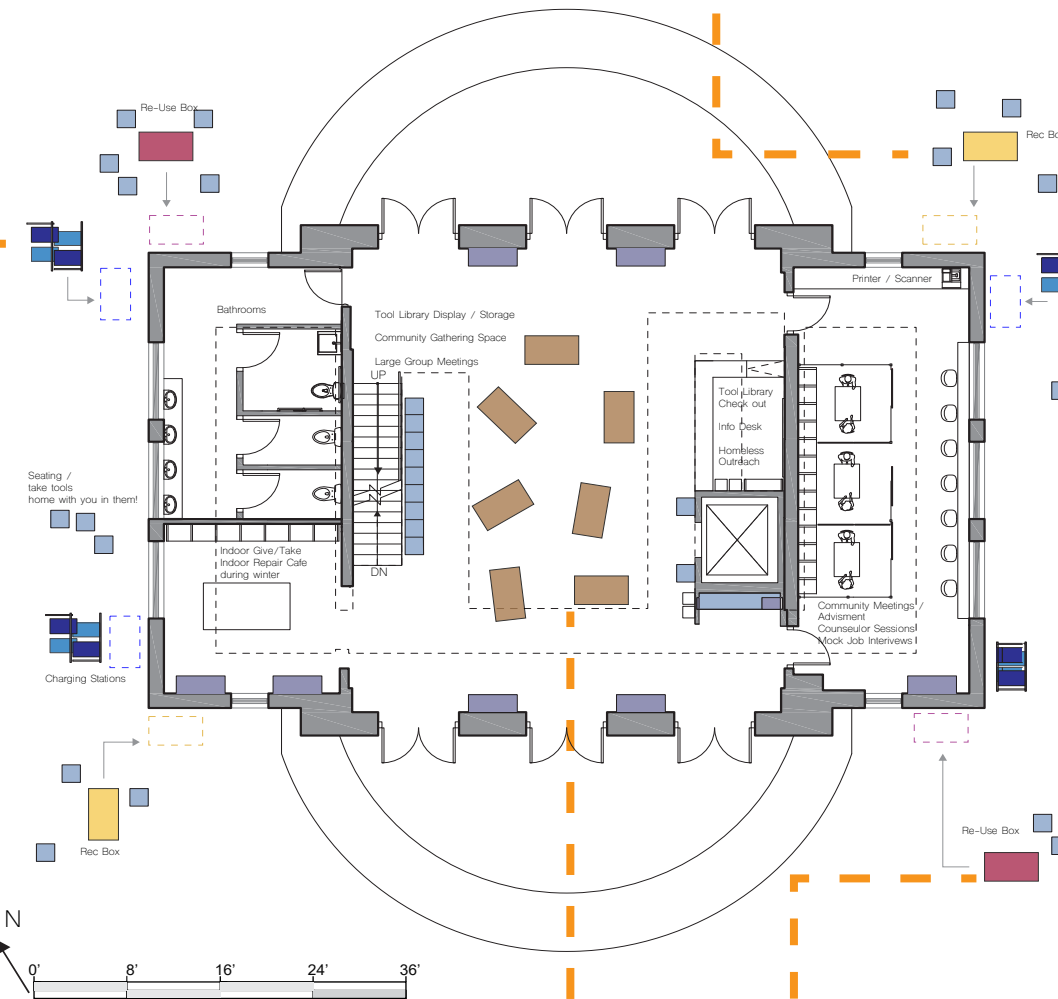

## TOOL BOX



Storage and display for tool library  
Work tables for maker-space in cellar  
Community tables

## RE-USE BOX

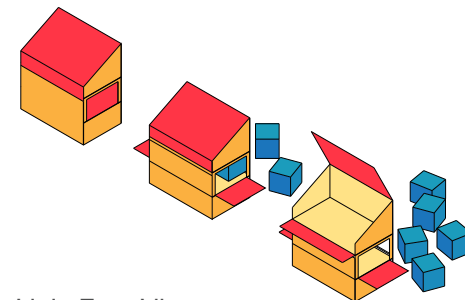

Little Free Library  
Give/Take Box  
Donation Window



Community members rolling the tools home with them in the chair/cart.

**TAKE ME HOME!** Community members can **take the chairs/carts home with them to carry the tools they borrow** and return them with the tools they bring back to the Tool Library.

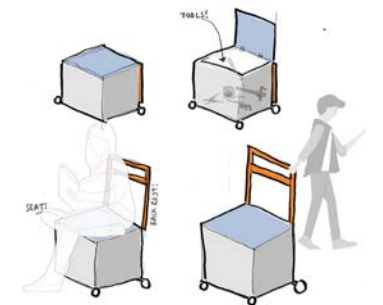



**OUTDOOR SIGNAGE**

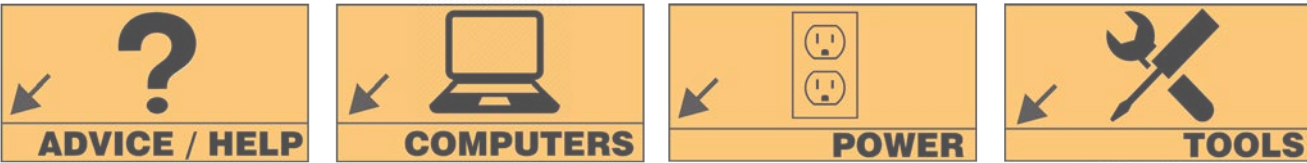

Recognizable icons for members of the community that do not speak English



**B.** Cross Section



# A...CHAIR?!

**TYPE:** Creative Repair Project

**SITE:** IKEA Bistro Chair

**BRIEF:** Find an object that needs repair. Come up with a design strategy to creatively repair the object.

**CONCEPT:** The original “site”, the bistro chair originally needed repair only in the one piece of wood that snapped off. Found hinges and scraps of wood were salvaged from my basement and used to further increase the flexibility of the chair design and conceptually change the function from a chair to a site with an **open-ended interpretation of its function**. By not defining a specific function for my new site, it allows the user to **alter the extensions** and chair to discover the uses for themselves. A bistro chair can turn into a piece of furniture with **infinite functions and possibilities** depending on the user’s needs with the addition of a few hinges, screws, scraps of wood and a **little imagination!**

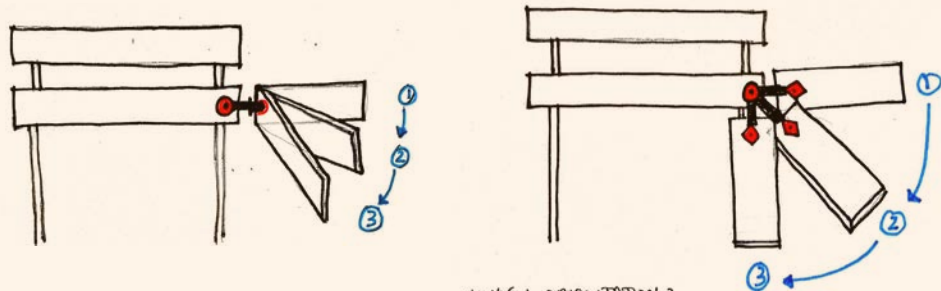



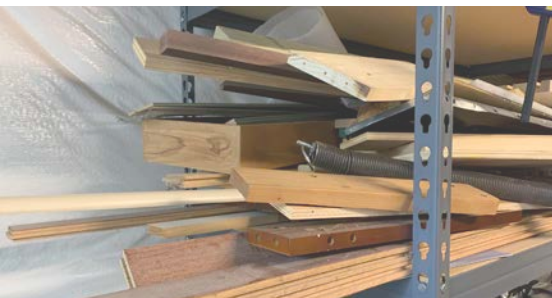
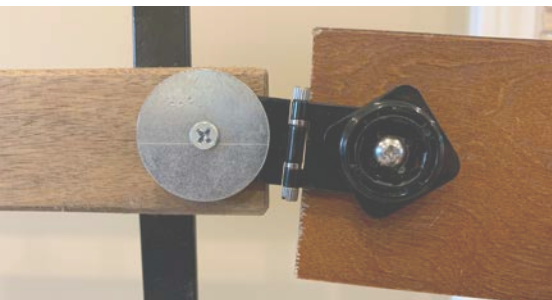

Celebrating differences.  
Hinge, Pivot,  
Multi-functional,  
Dynamic, Joyful, Playful  
Found scraps of wood  
and hinges

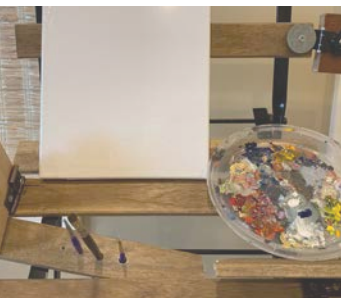
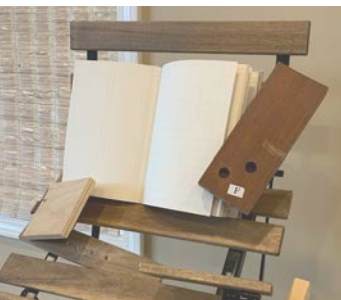
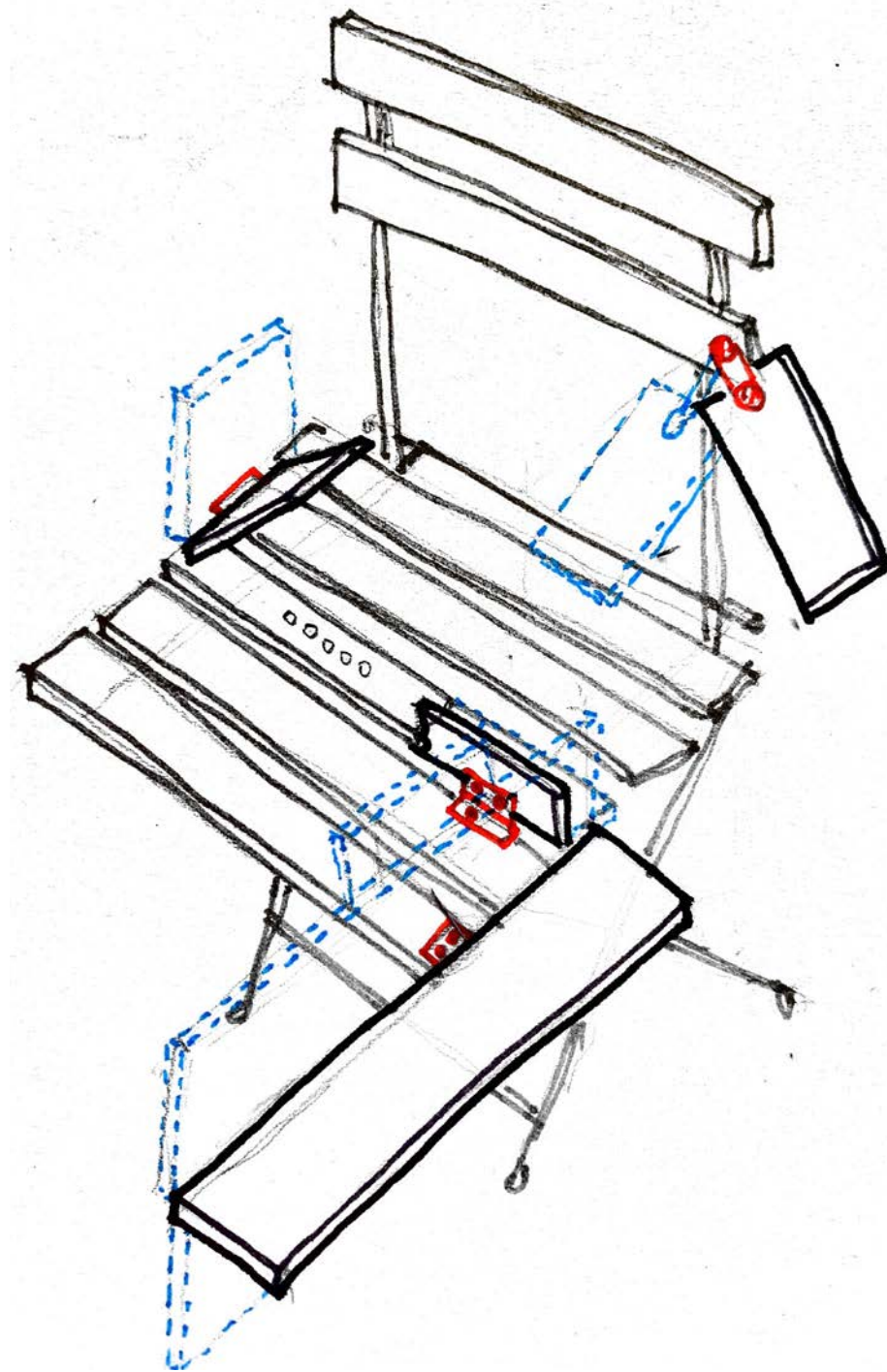
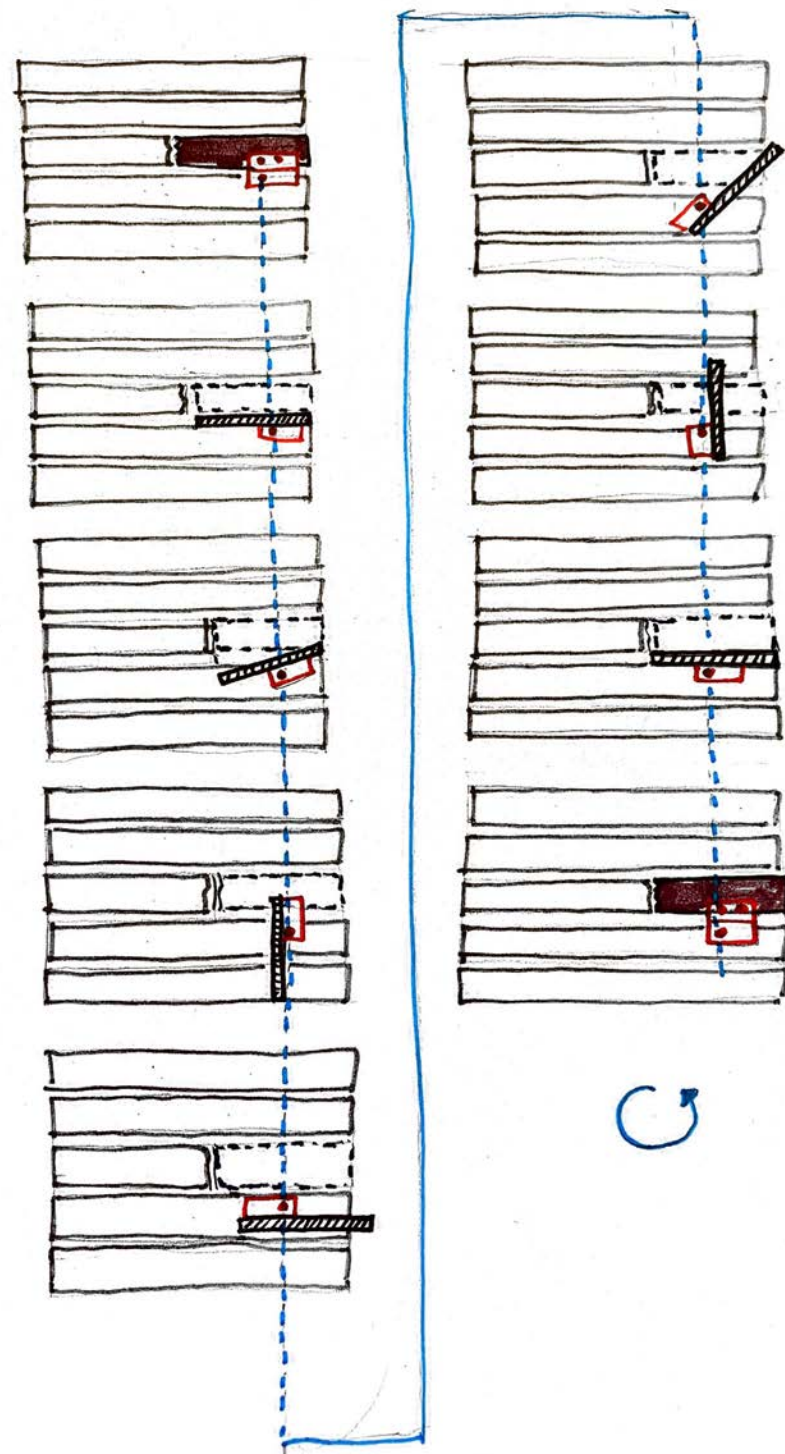

Book Holder,  
Shelf, Pencil  
Holder, Painting  
Easel...Endless  
possibilities!



# MEANDERING PATHS

**TYPE:** Library

**SITE:** Brooklyn Public Library - Pacific Branch  
25 4th Ave. Brooklyn, NY

**BRIEF:** Re-design the existing Pacific Branch Brooklyn Public Library to accommodate the range of users, from children, teens, adults, and the elderly.

**CONCEPT:** My design proposal for the library project focused on **educational support for the community**. The concept was driven by the **Fulton Street elevated train tracks that were formerly adjacent to the site**.





The **conceptual framework** of the design project is driven by the circulation paths derived from the traces of historic, and now demolished, **Fulton Street ELEVATED TRAIN TRACKS** that were adjacent to the site. The intention for this library design proposal was to create a space that **historically preserves the essence of the past by spatially enhancing the experience within the library** by adhering to the dynamic circulation paths created by the elevated train tracks.

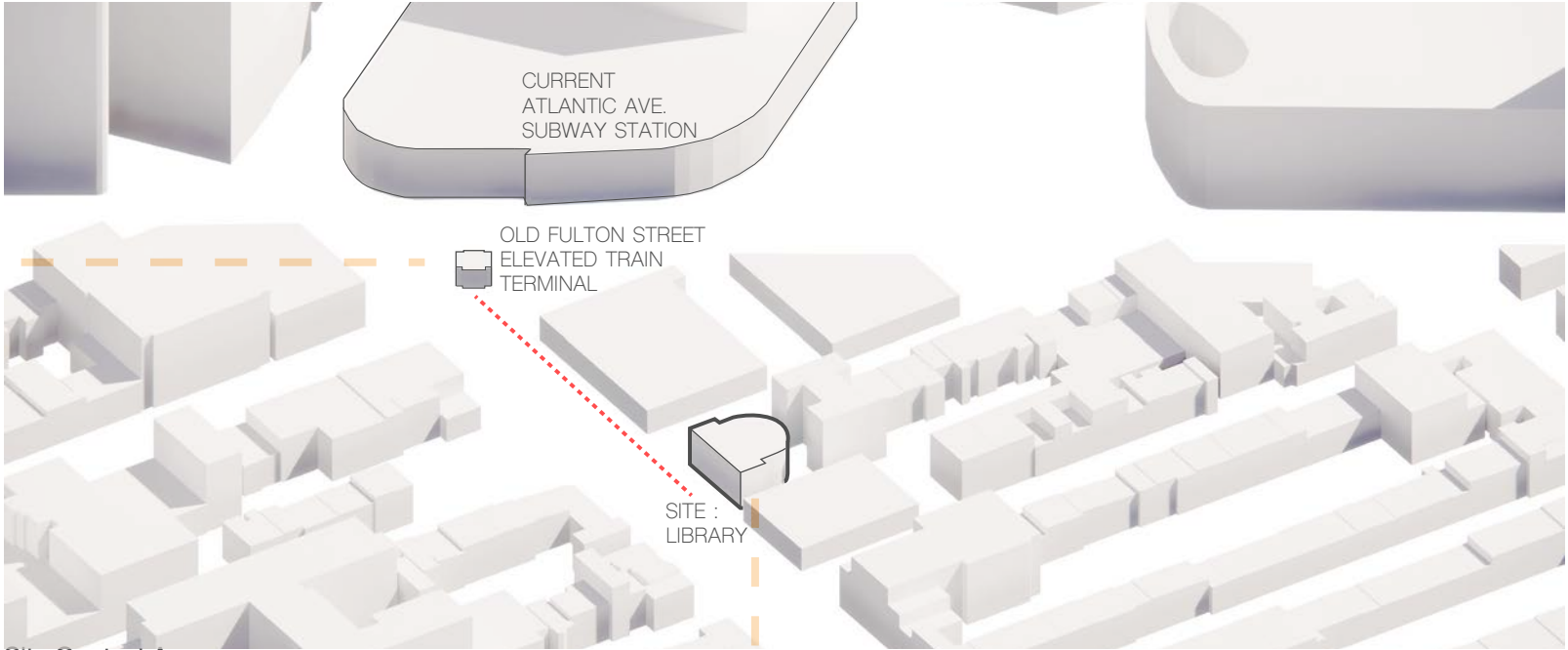

Site Context Axon



Process Section Sketch - Bringing the elevated train track experience into the library.



Elevated Train Near Library - Fulton Street Line. 1888-1940

The **structure** of the **EXISTING BOOKSHELVES** were an essential design feature of the library. The cast iron bookshelves act as the structure that holds up the mezzanine floor. The stacks were required to remain in place but the mezzanine floor plate could change with additional structure.

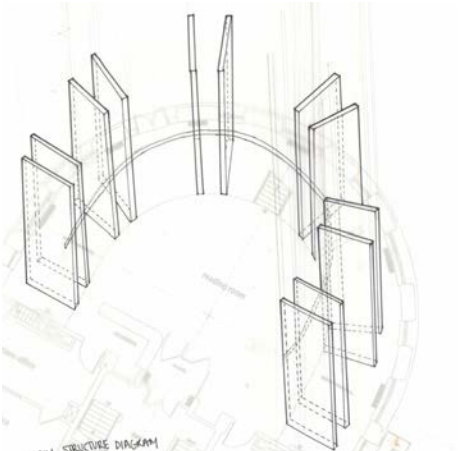

Existing Structure Diagram

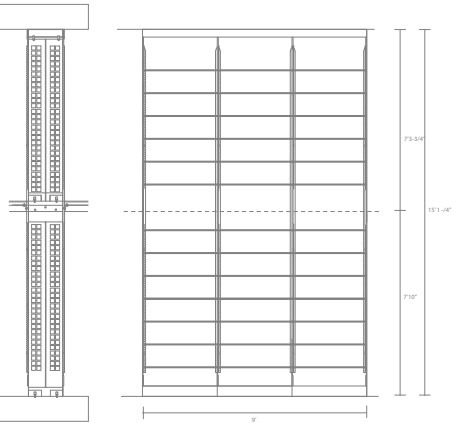

Elevations of the Bookshelves



Pacific Branch Library in the 1900's.



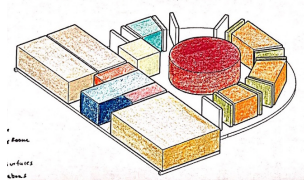
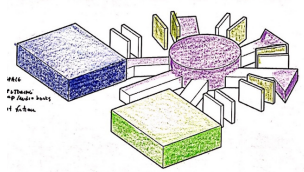
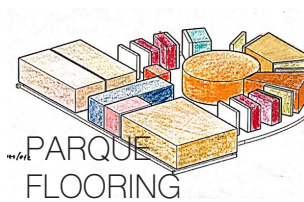
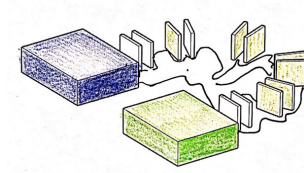
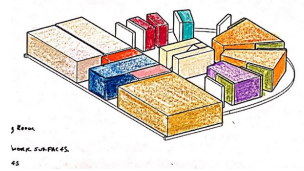
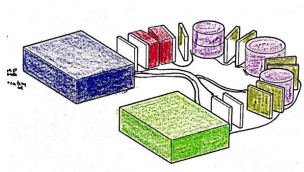

For the program, I chose to focus on is the Brooklyn Public Library's

# **ADULT LITERACY INITIATIVE.**

This initiative helps the community not fluent in English to learn the language, experience mock jobs interviews, and take literacy tests.

The diagrams on this page represent initial **program and spatial layout studies.**

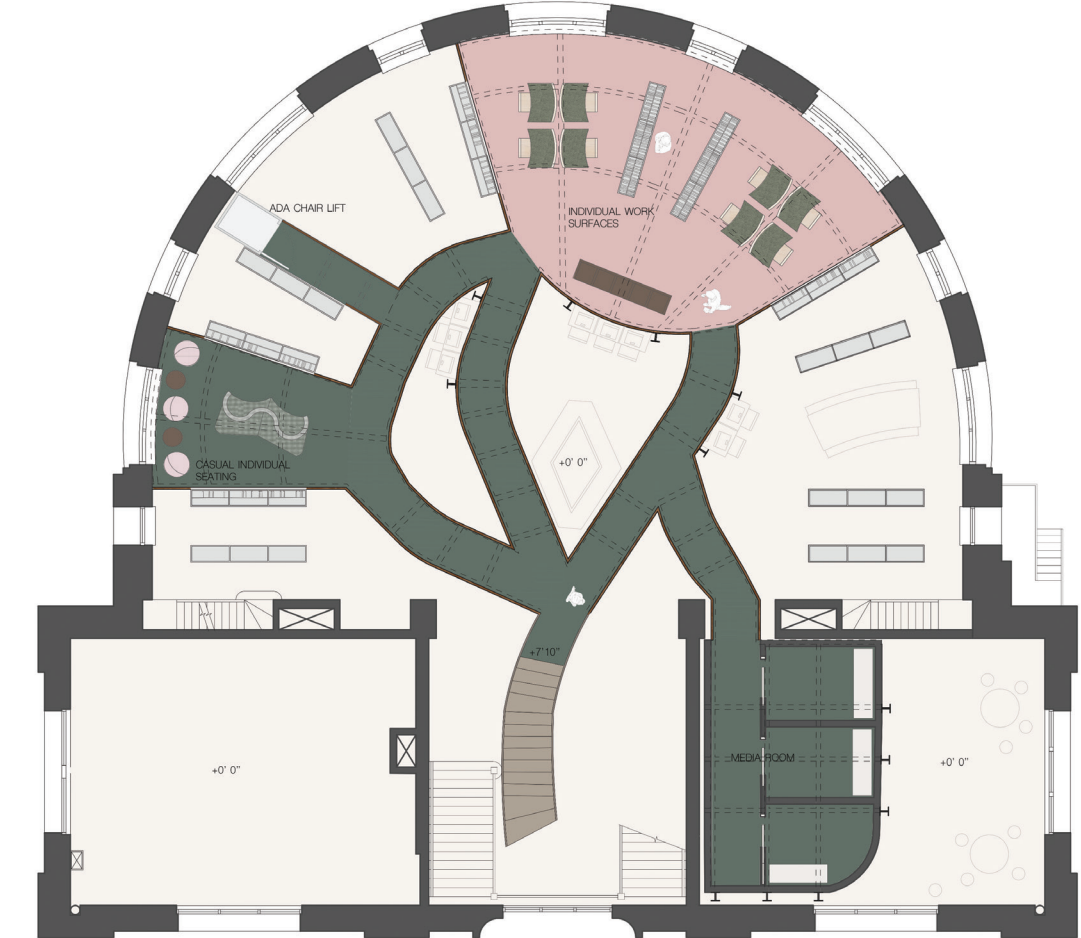

Mezzanine Floor Plan

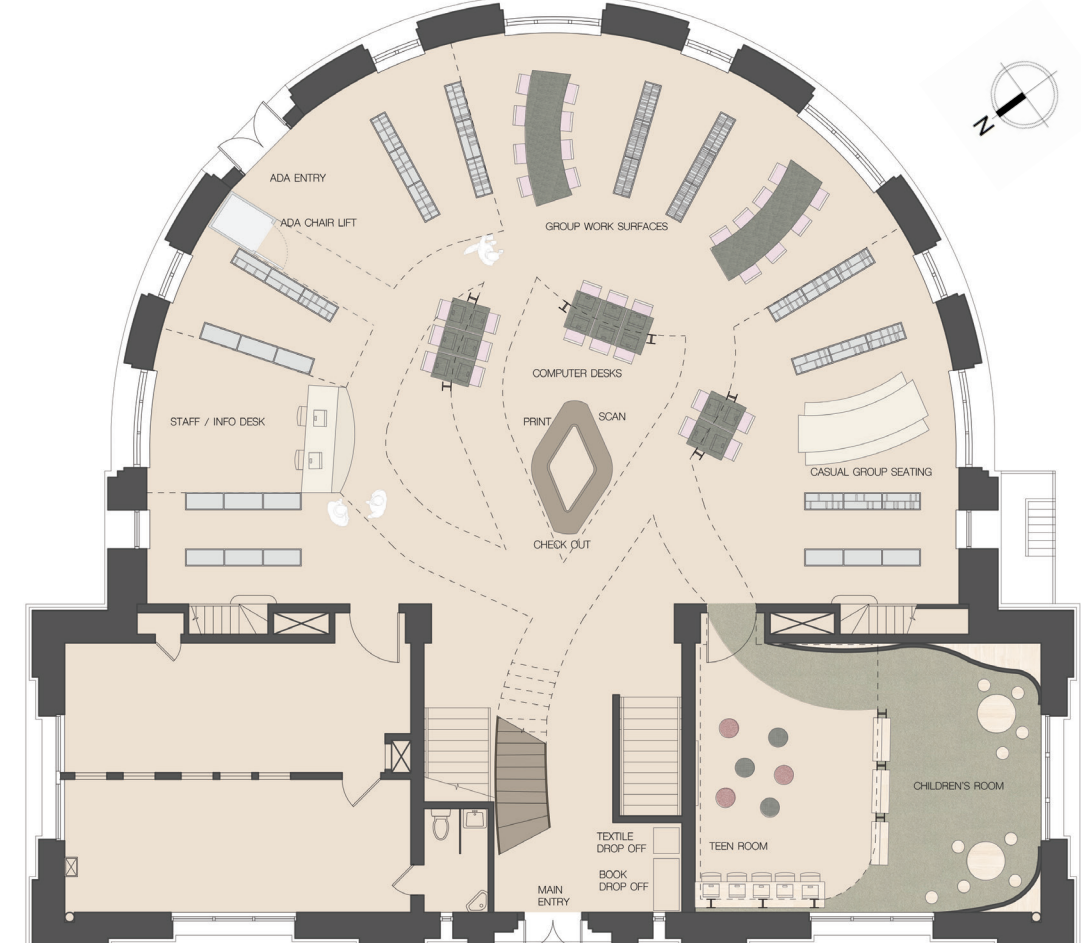

First Floor Plan



Wool for Chairs



Parquet Flooring



Grey-Green Paint for Walls



Stained Wood Tabletops



Oak Furniture



Oak Veneer Ceiling



Carpet



Rubber Tile Flooring for Track



Painted Metal Guardrail



The **STRUCTURE** of the mezzanine relates to the **iron work of the elevated train lines**. The underside of the mezzanine was developed to guide circulation.

The **LIGHT RAIL** mimics the **paths of the subway trains**, but with a custom design that relates to the architecture of the building and circulation below.

**CUSTOM DESIGNED TABLES** The design was inspired by a **railway switch**.

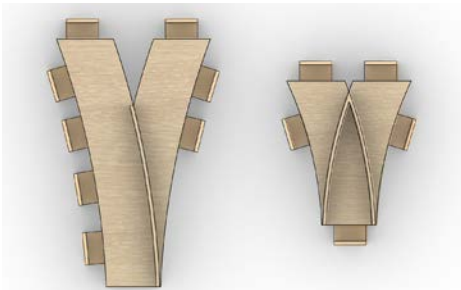
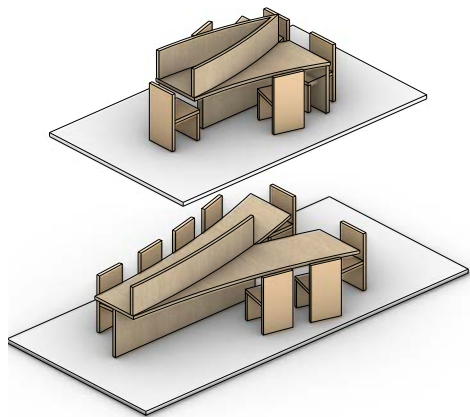

Custom "Railway Switch" tables



Railway Switch

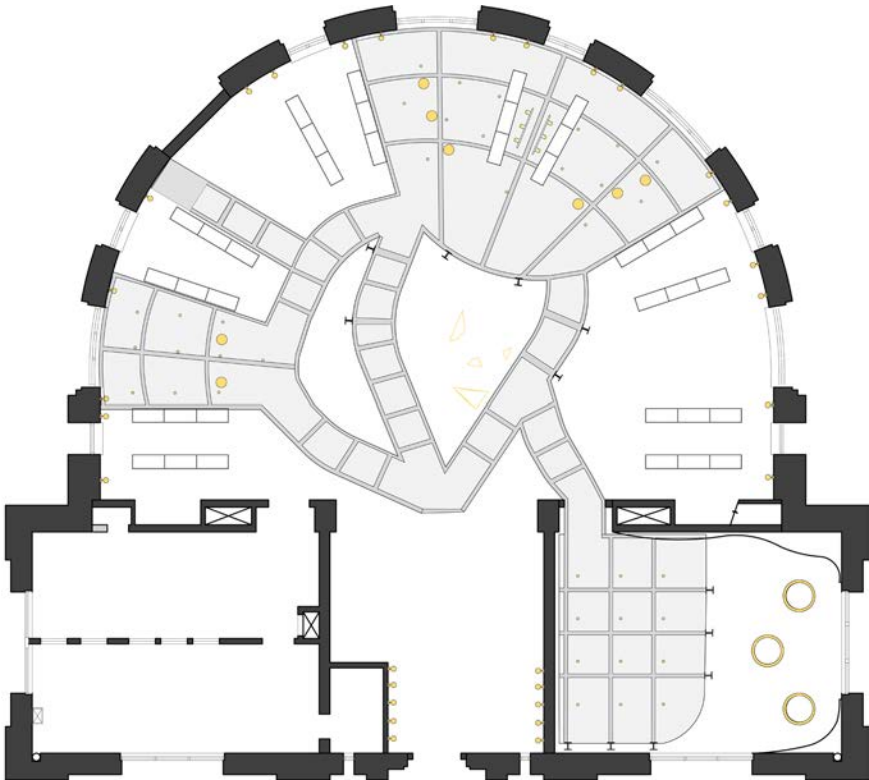

RCP First Floor

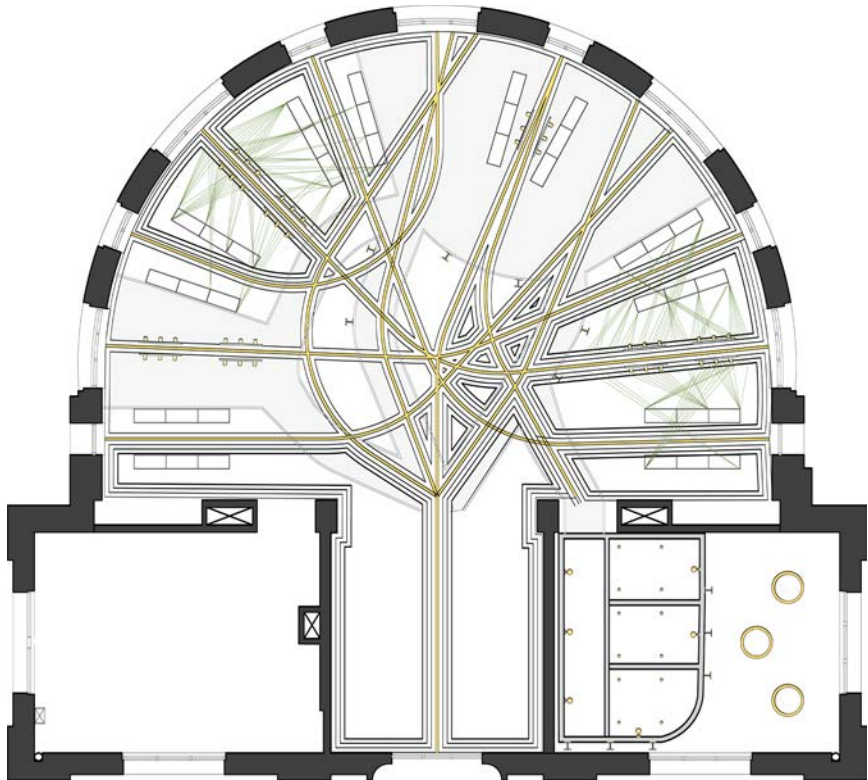

RCP Mezzanine Floor





# THE TREE HOUSE

**TYPE:** Cooking School and Community Center for Kids

**SITE:** Øster Allé 1, 2100 København, Denmark

**BRIEF:** Adapt an existing 1970's modular building into a **cooking school on the first floor for 20 children.** Design a **community center on the second floor** with a library, workshop space, lecture space, etc. **Add a connection to the park** behind the site.

**CONCEPT:** Create a **fun and playful space for kids** by bringing the **symbol of a tree** into the space to relate to the growth of children (tree of knowledge) and the connection to nature. Using terms such as tree houses, bird's nest, cardinal's wing, etc., the design lets the **kids relate to the space and lets their imagination run wild!**







## BLUE JAY'S NEST

a quiet area for **contemplation**, with close connection to the park with a large window and predominantly glass ceiling. Being slightly elevated and cantilevered off the existing building, it will give the **sense that the kids are in trees**.

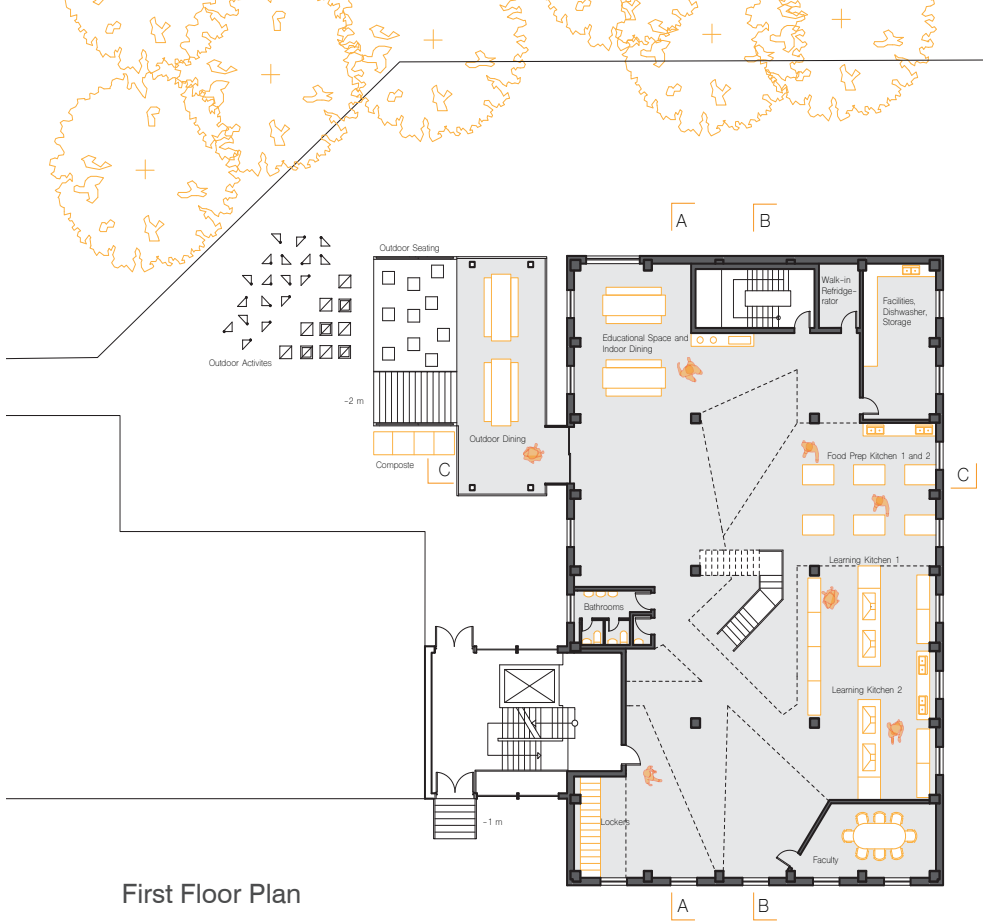

First Floor Plan

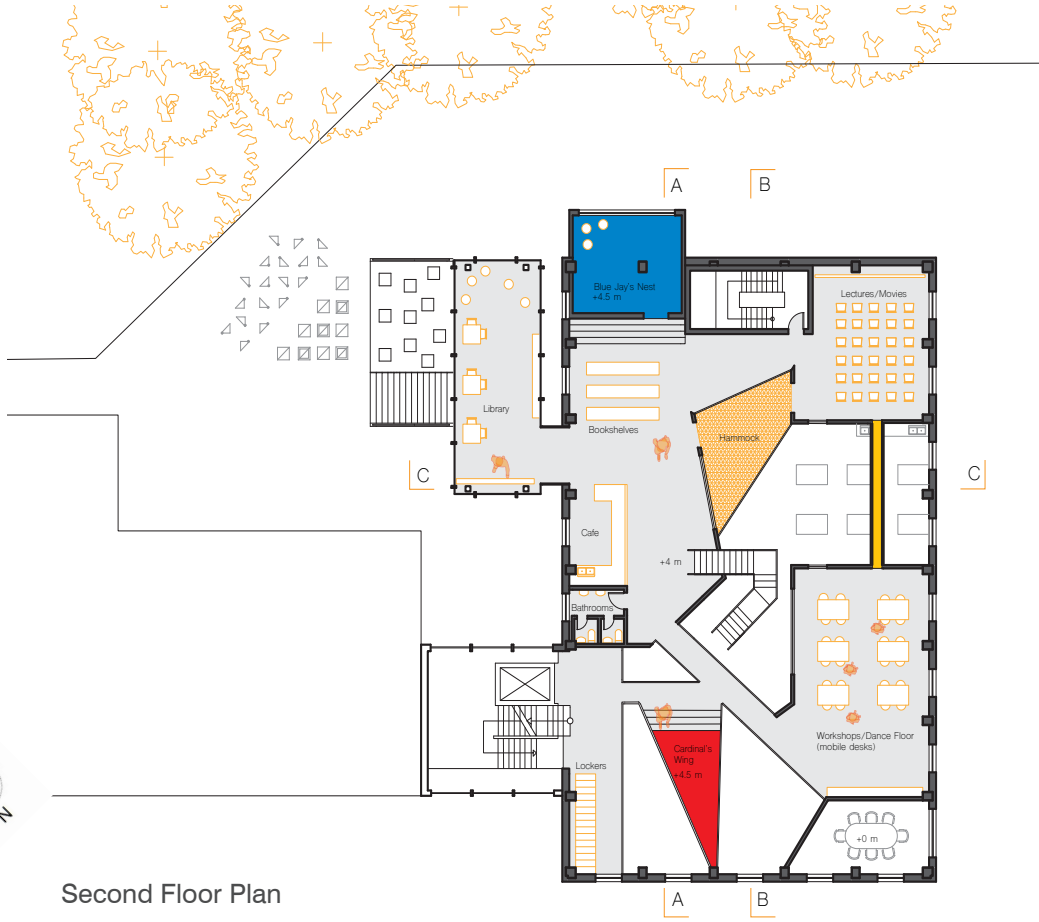

Second Floor Plan



## HAMMOCK

acts as an **alternative pathway** between the two tree houses where they “browse” and “watch” and as a **space to relax, read, watch below, etc.** Railings on both sides protect the kids.

## CARDINAL'S WING

an elevated platform kids can look down over the first floor through the frosted glass floor and railings. It will seem **as if they are flying like a cardinal**. The skylight above them will give close access to the sky to look at the passing clouds.



Perspective of the Learning Kitchen with the Crawl Tube and Tree Houses above.

## CRAWL TUNNEL

an **alternative circulation route for the kids** between the tree houses where they “watch” and “create”. It is above the Learning Kitchen, giving the kids **a unique view** of the space.







Tree Houses - Exterior



Tree Houses - Interior

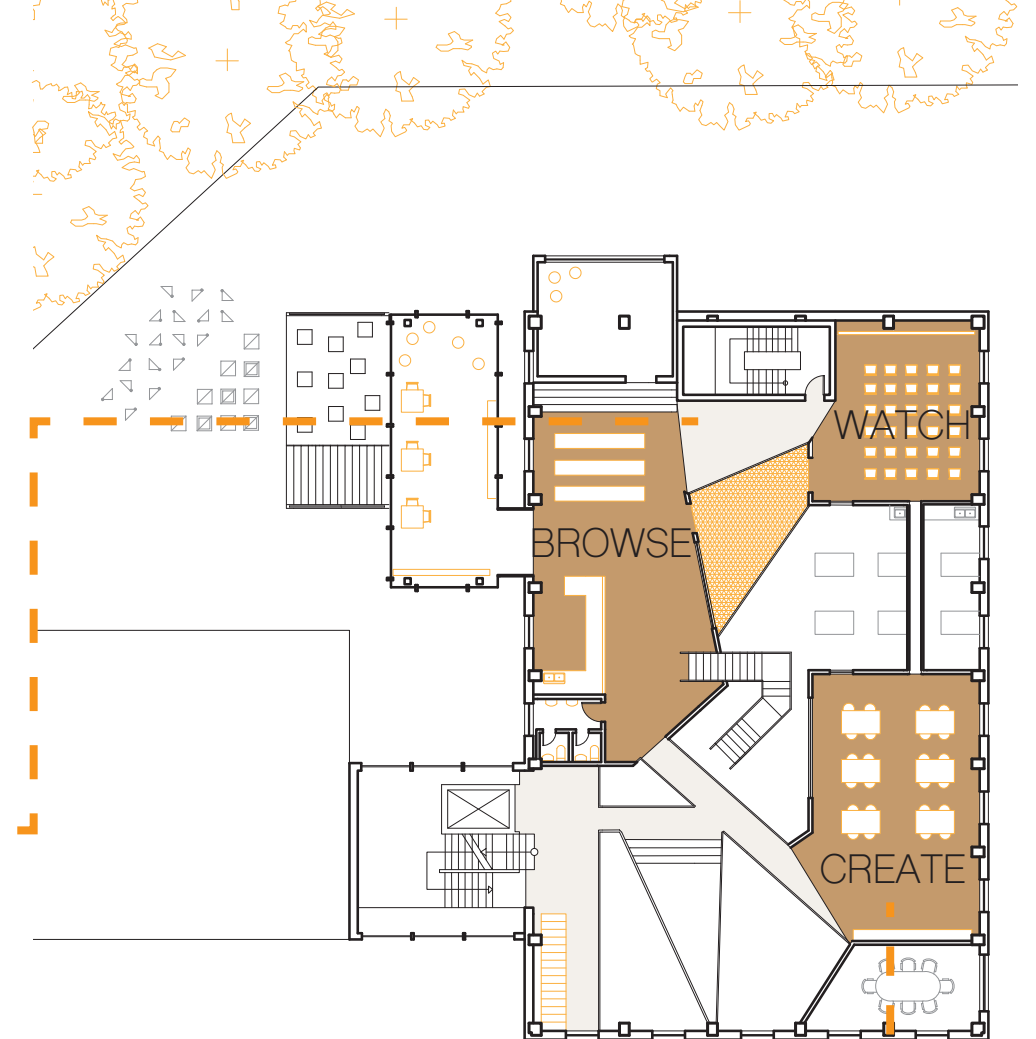

## THREE TREE HOUSES

on the second floor, connected by catwalks that **hold the various programs**. Each has windows to provide **views** to the other tree houses and the first floor.

### 1. BROWSE

library books, cafe, access to outside library and bird's nest.

### 2. WATCH

Holds lectures and movies with a pull down projector screen.

### 3. CREATE

Tables for workshops and storage along back wall. The tables can be rolled to the side to open the space up for activities such as dance classes.



# FARM-TO-TABLE

**TYPE:** Bar and Cafe

**SITE:** 181 Smith Street, Brooklyn, NY

**BRIEF:** Working in a **team of three**, design a bar and cafe. Compile the drawings into a **Construction Drawing package using AutoCAD**. From the schematic design phase, to the plans, sections, RCP's, interior elevations, door and partition schedules, fixtures, materials and lighting selection, etc.

**CONCEPT:** A farm-to-table bar and cafe **supporting local farmers** while also providing the local community with fresh food and classes to teach them about the process.

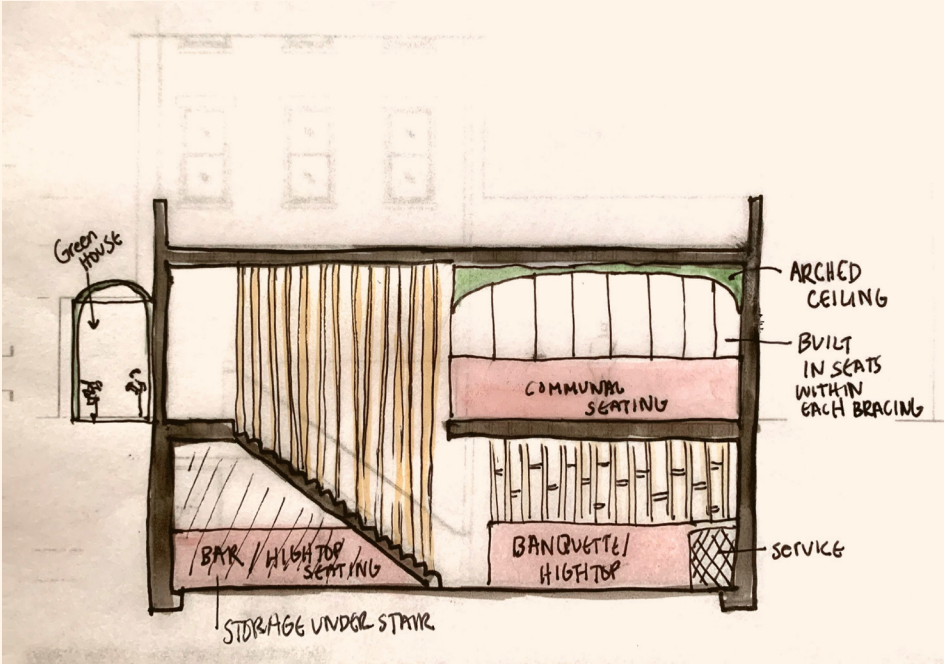

3" = 1'-0"

2X8 WOOD STUD

EXISTING FURRED WALL

BRACKET ATTACHED TO 2X8 WOOD STUD

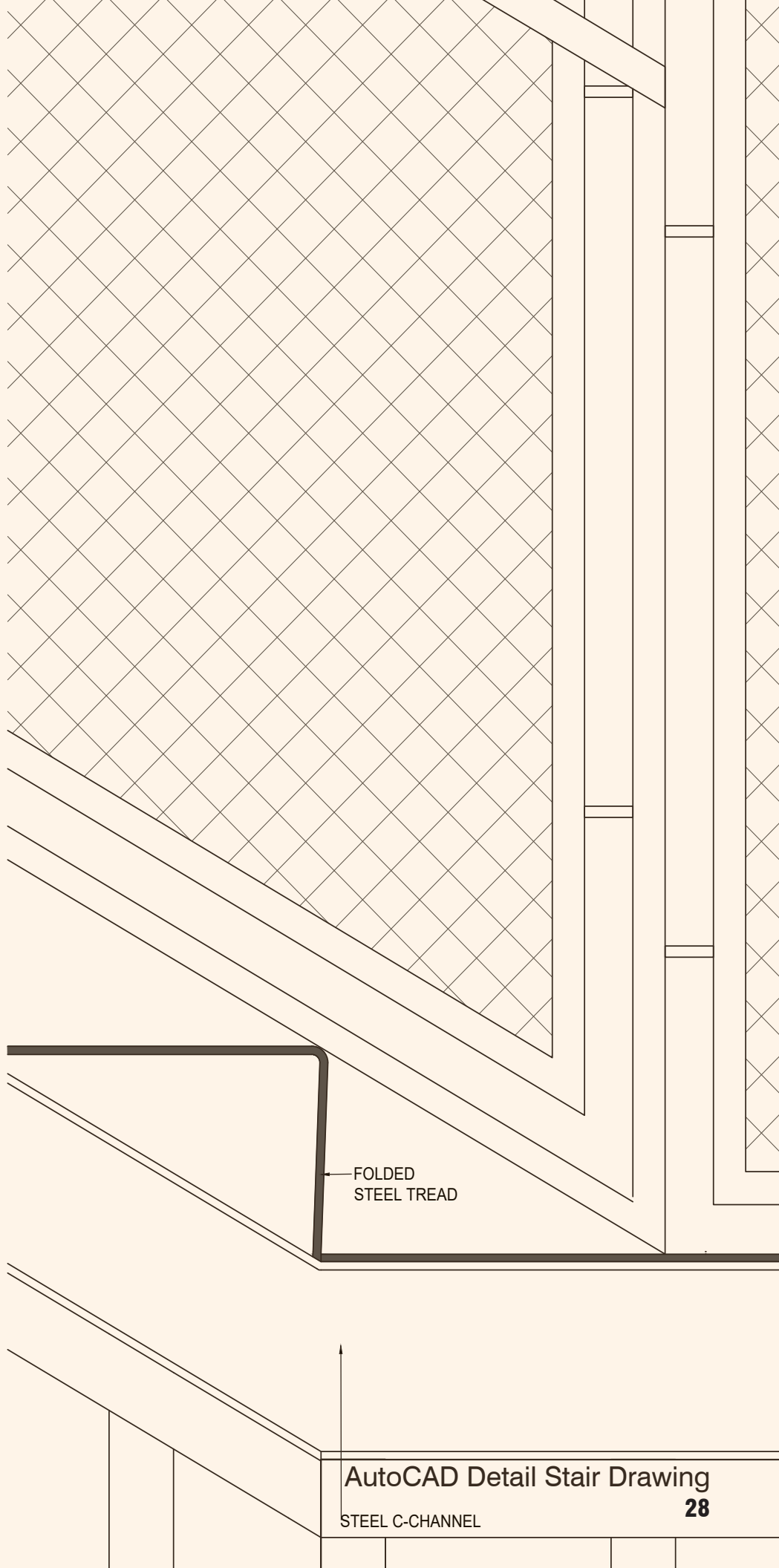



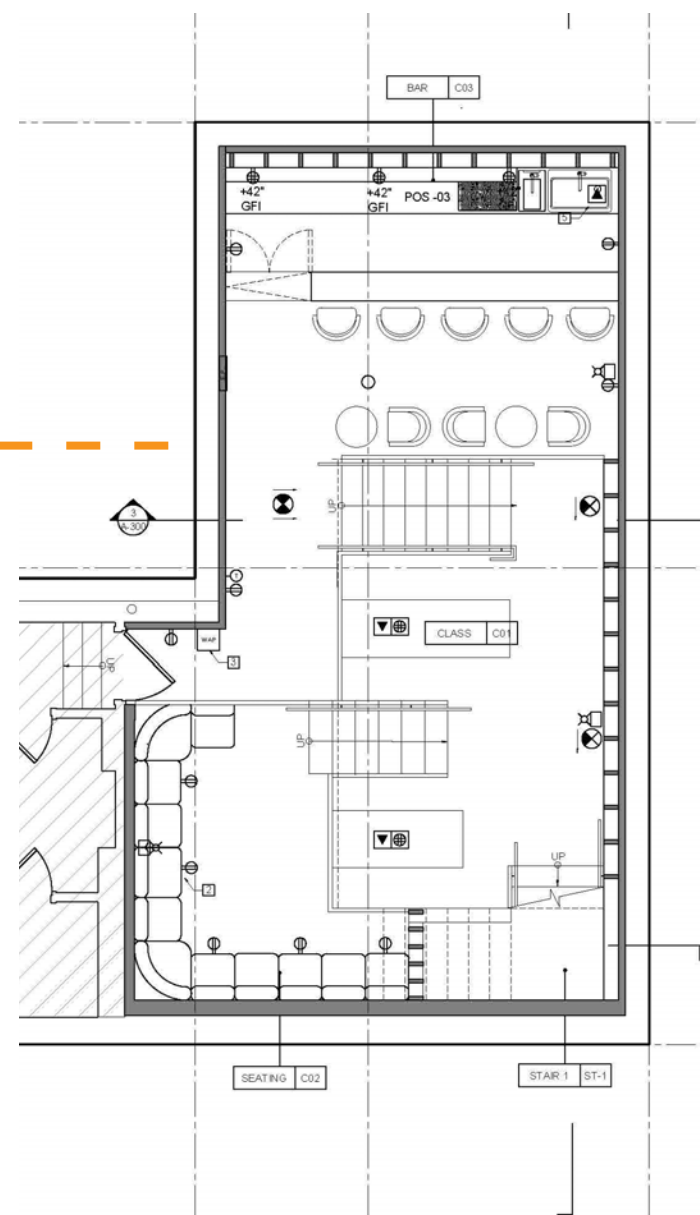
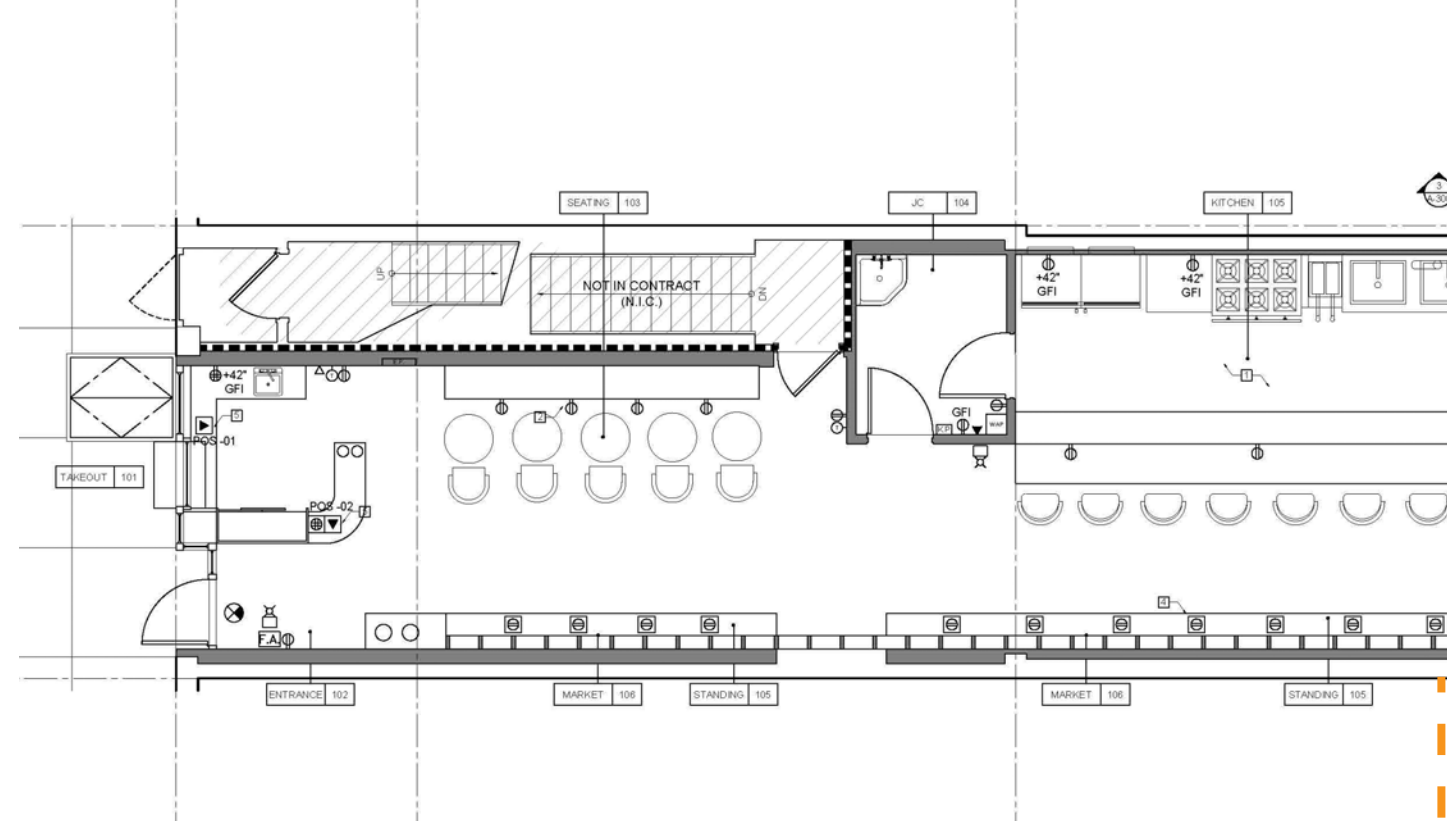
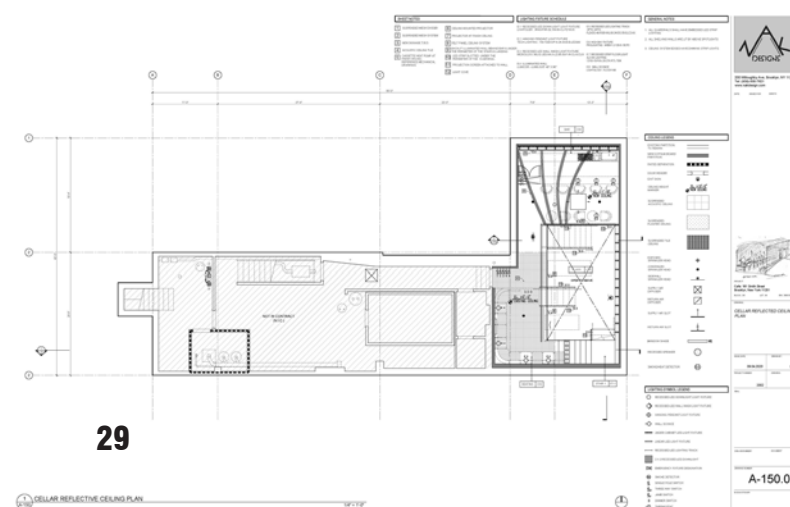
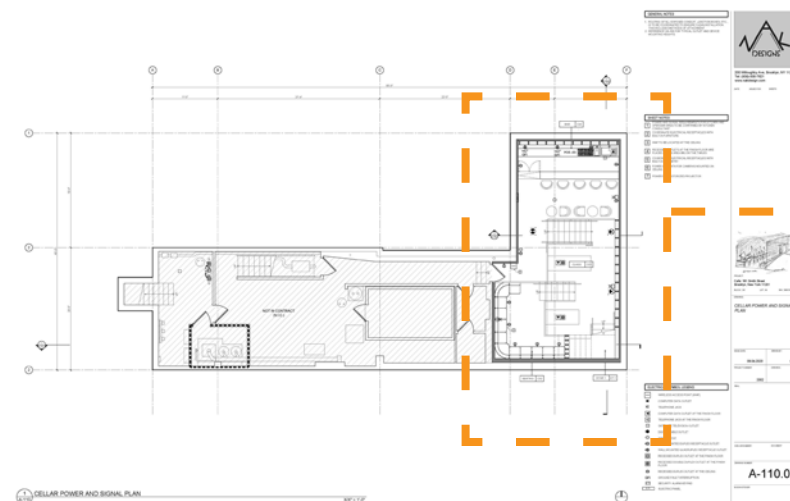
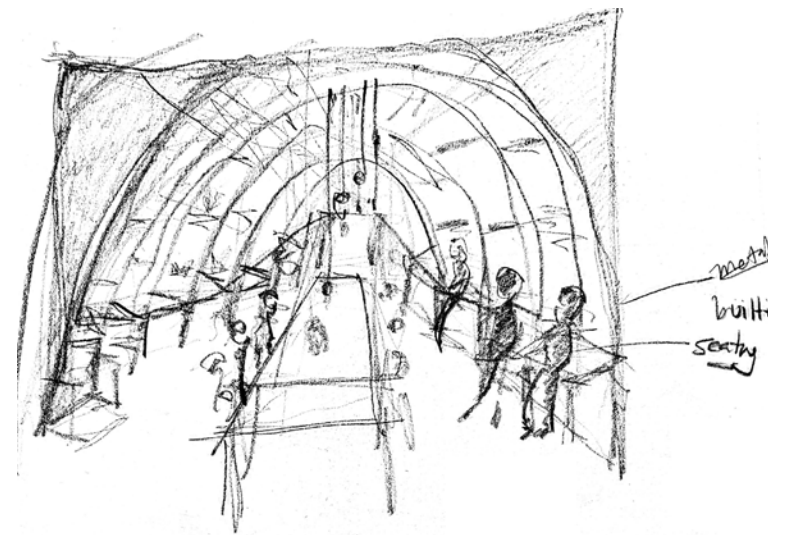

DEMO PLANS  
CONSTRUCTION PLANS  
POWER AND SIGNAL PLANS  
REFLECTED CEILING PLANS

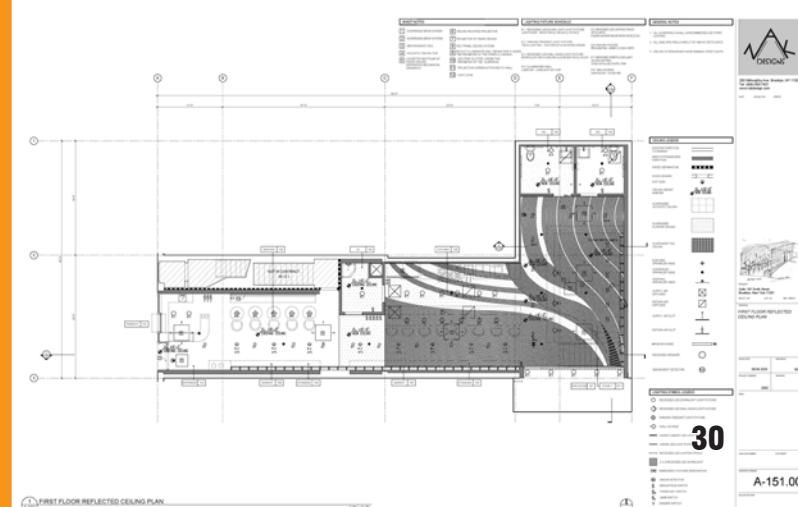
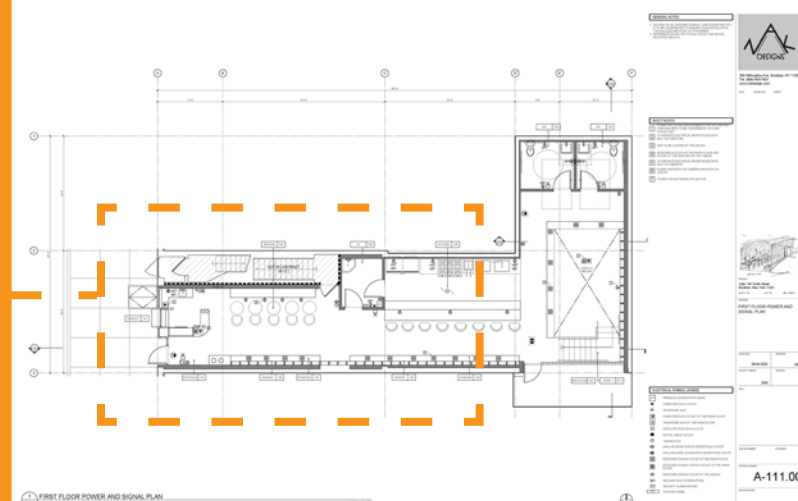
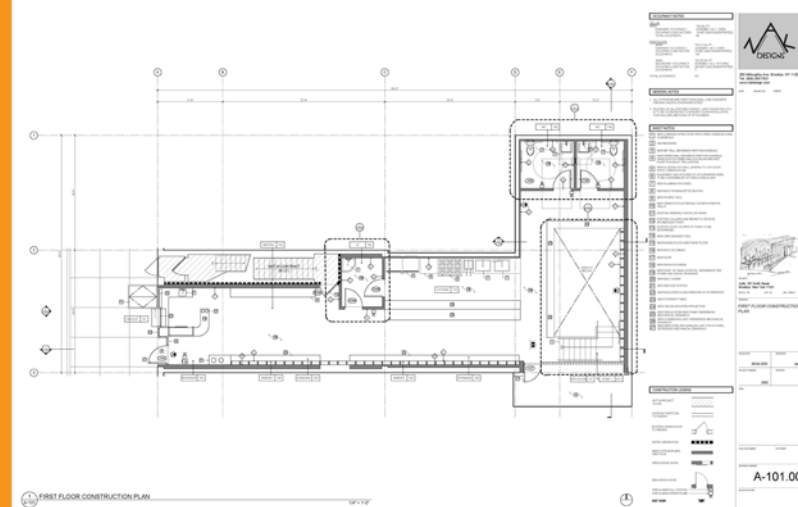
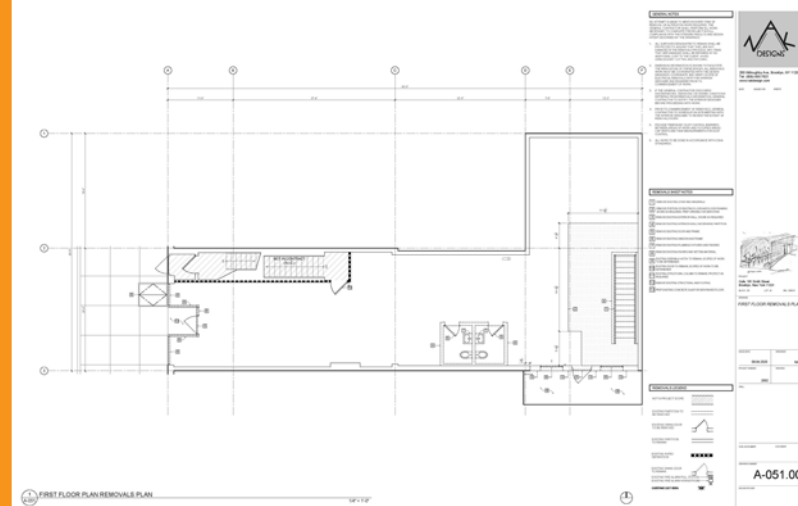



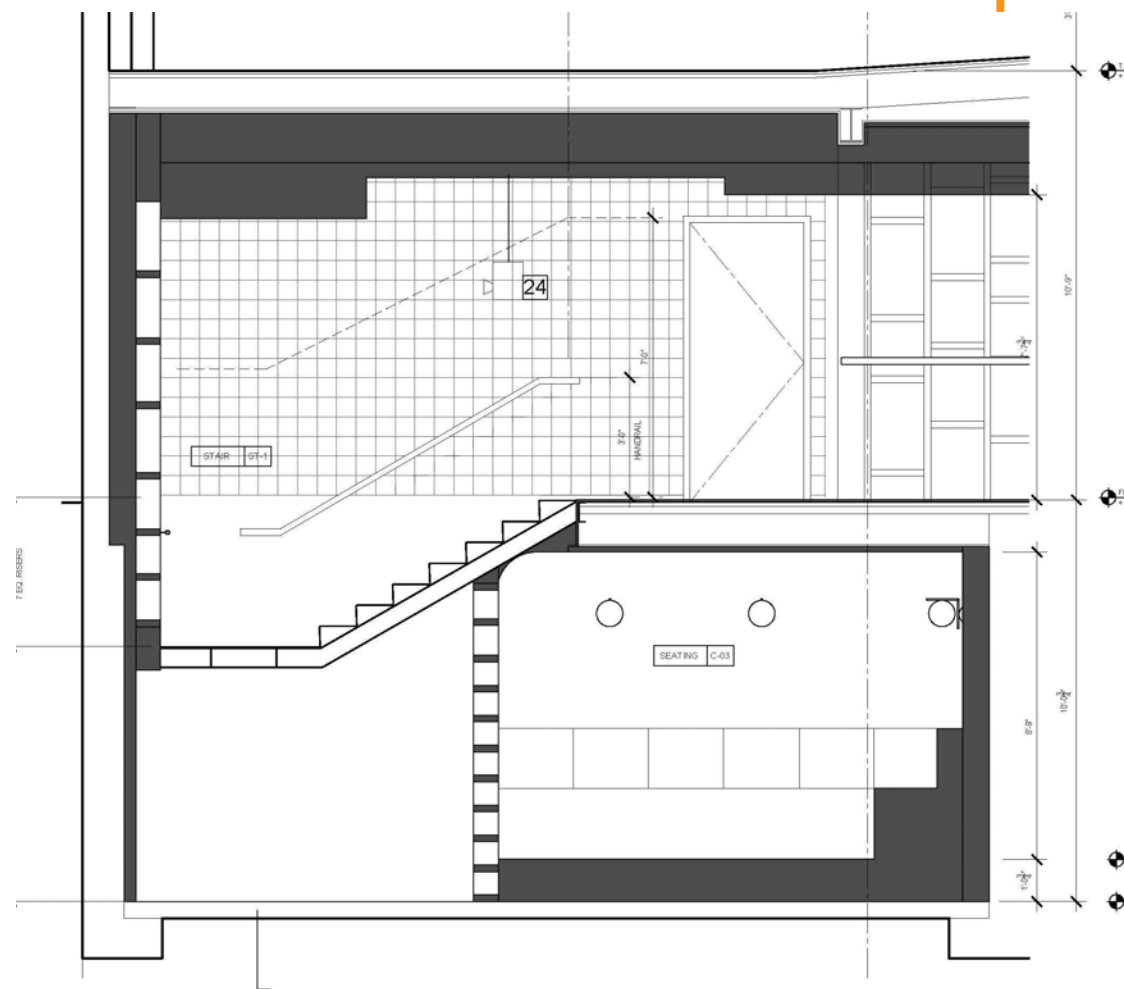
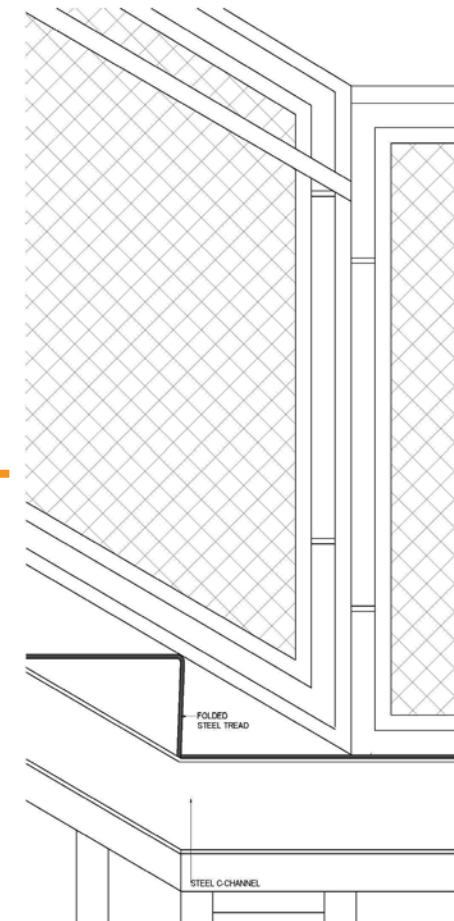
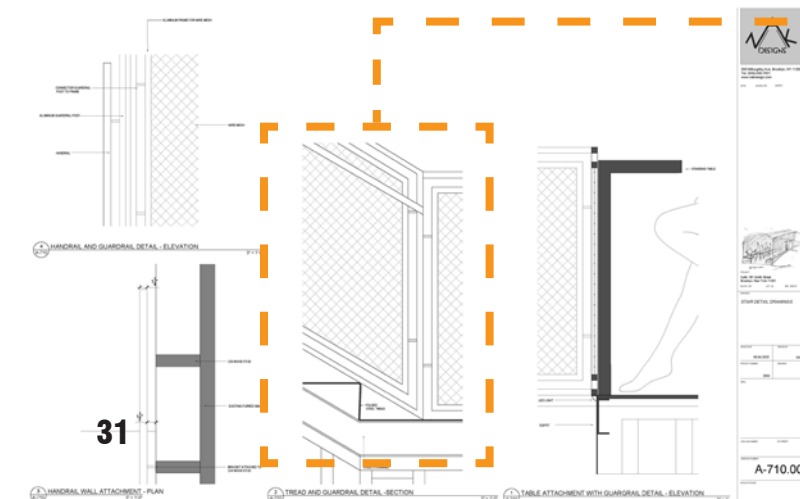
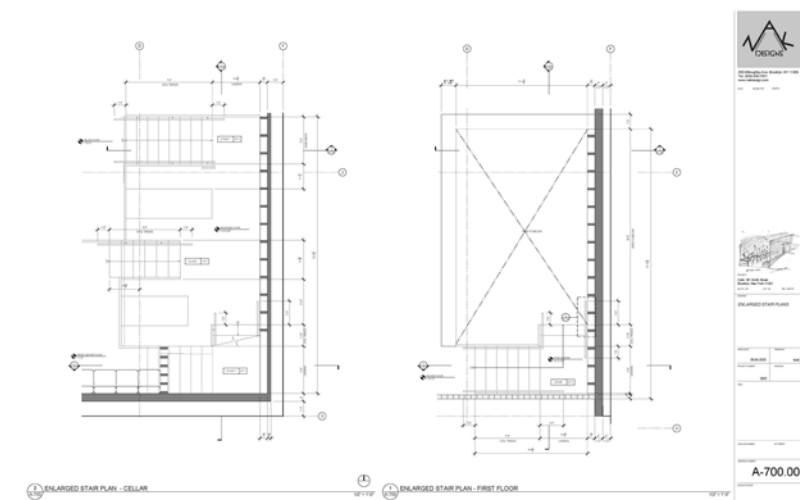
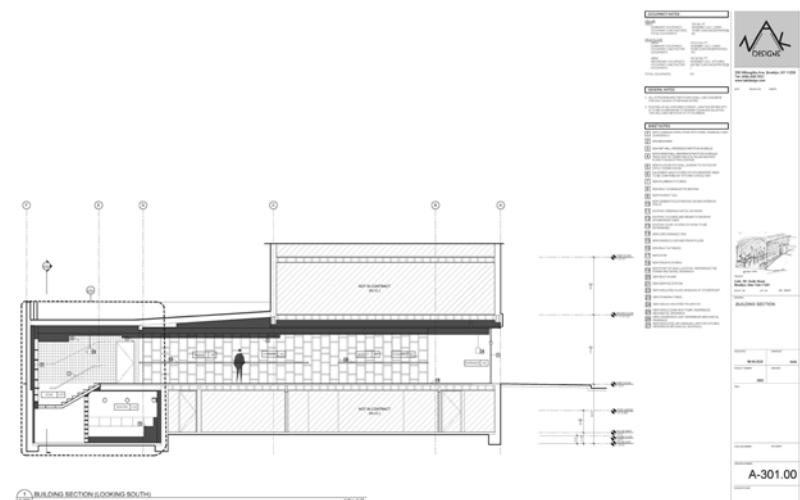
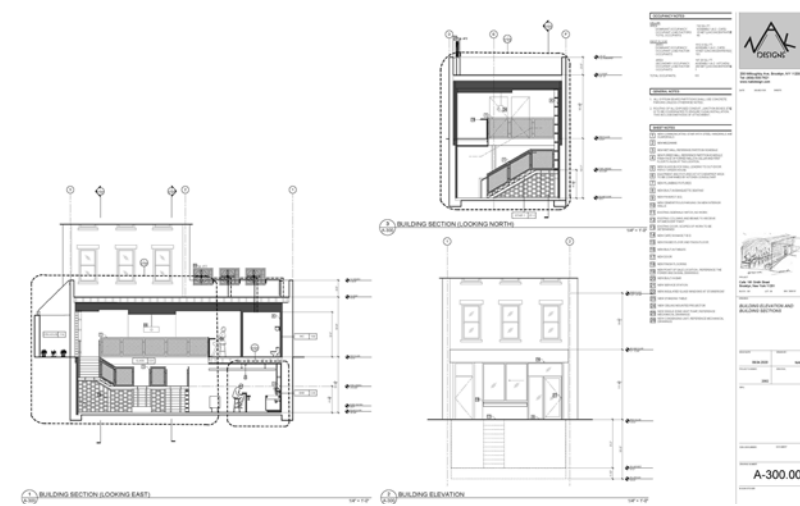

# SECTIONS ENLARGED STAIR PLANS DETAIL STAIR SECTIONS STAIR DETAILS MILLWORK SECTION

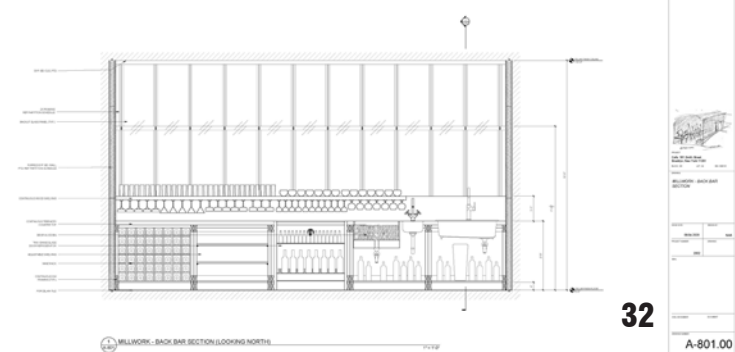
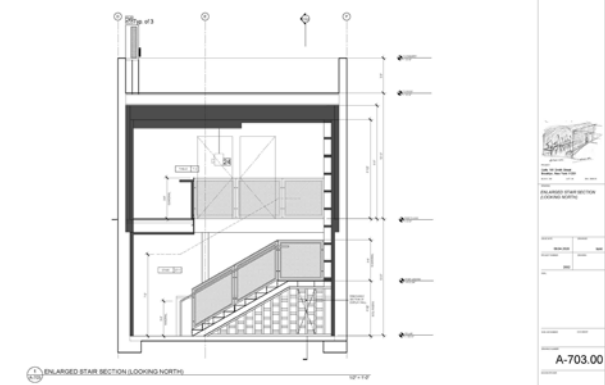
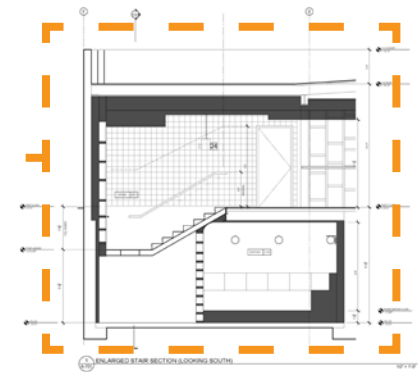
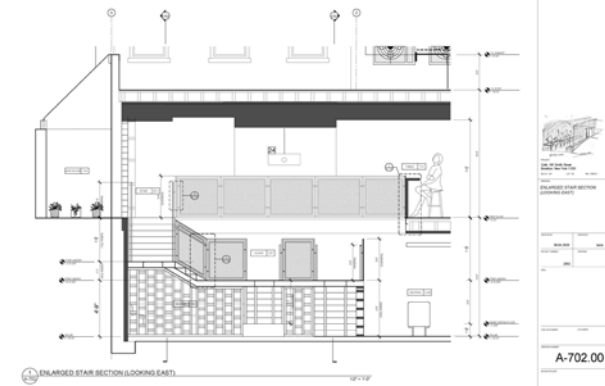







# THE CARVED DWELLING

**TYPE:** Residential

**SITE:** 1065 Fulton Street, Brooklyn, NY 11238

**BRIEF:** Design a Brooklyn home for a **multi-generation family of four**. A family profile was given to us by a classmate and a collection piece was assigned by the professor as the conceptual starting point for our design.

**CONCEPT:** My clients were **Orthodox Jewish**. The son likes to play the piano. My intention was to create a **safe space for prayer, reflection, and solitude for this reserved family** away from the busy streets of Brooklyn just outside their window. The **shofar**, a horn used as a musical instrument, was the assigned piece for my **conceptual framework** for the project.





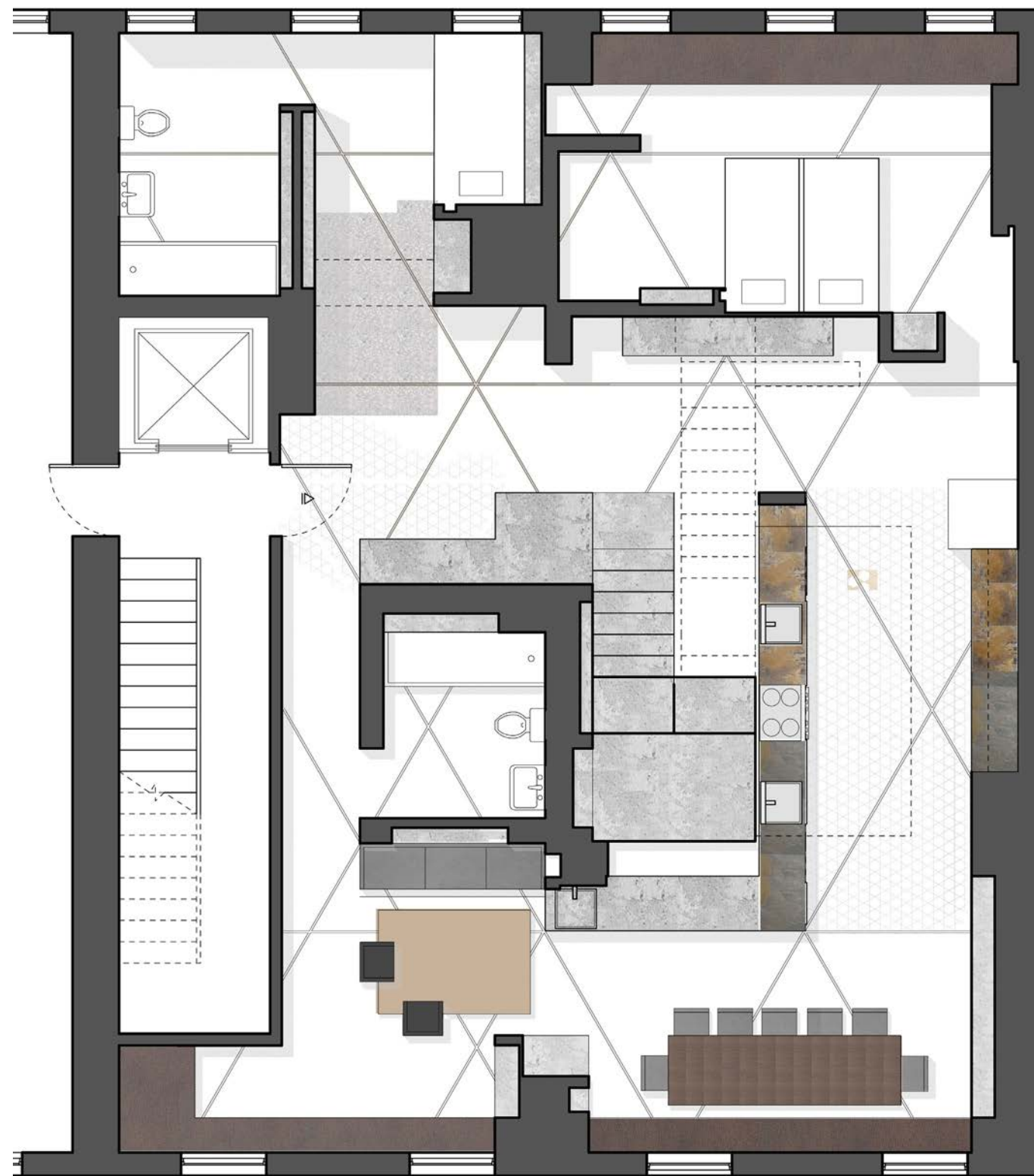
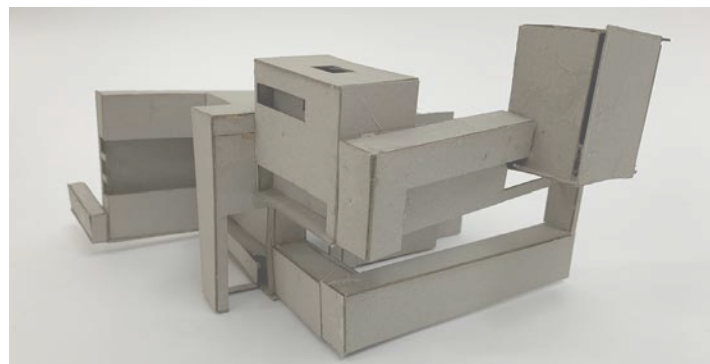
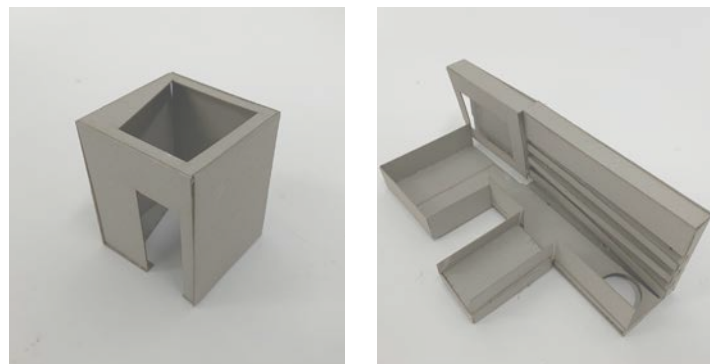
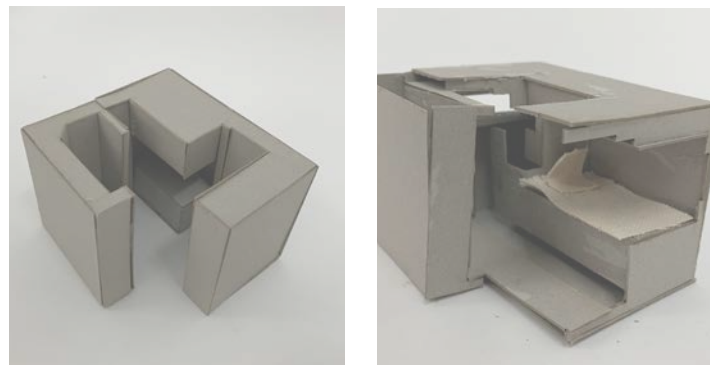
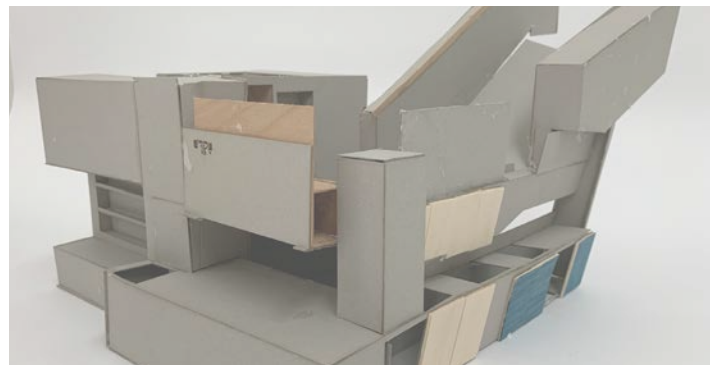
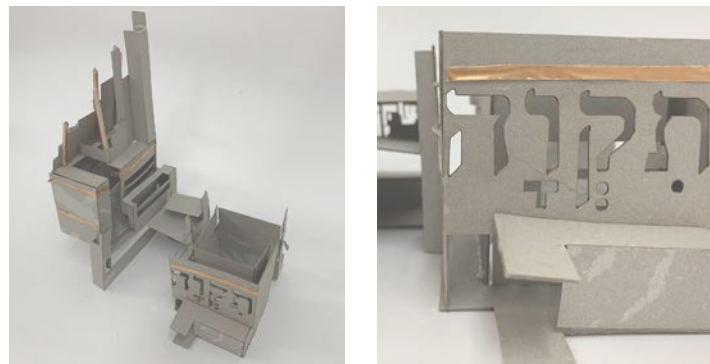

First Floor Plan

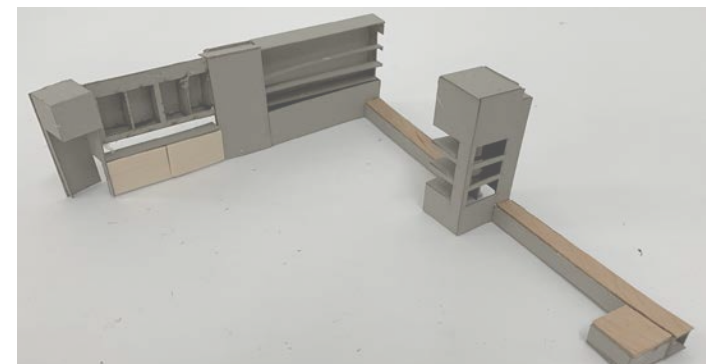
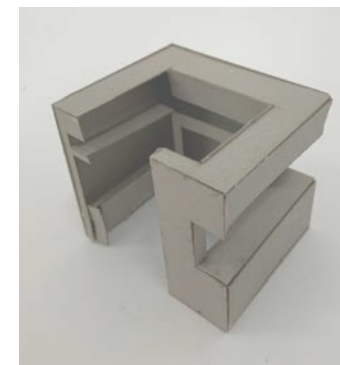
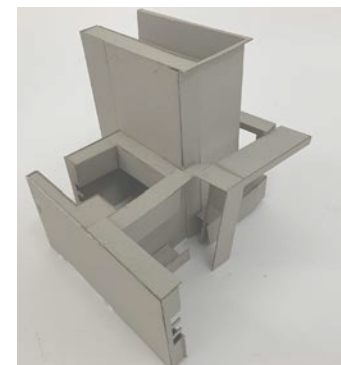
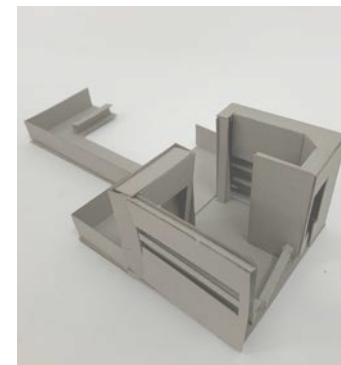
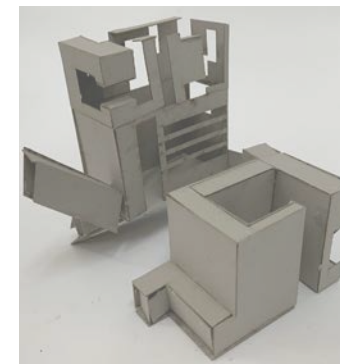
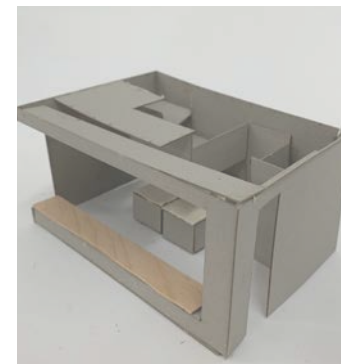



A **CARVED AWAY, MONOLITHIC SPACE** was inspired by the **ancient Jewish Musical instrument, the Shofar**. The **hollowed-out interior, spiral growth pattern, and impure surface texture** inspired the design concept of the dwelling.



A **CENTRAL STAIR CORE** holds the various **programs** of the dwelling. Function of spaces was the primary method of carving the space, only carving away what was required to perform each program, such as a shelf, bench, or bed.

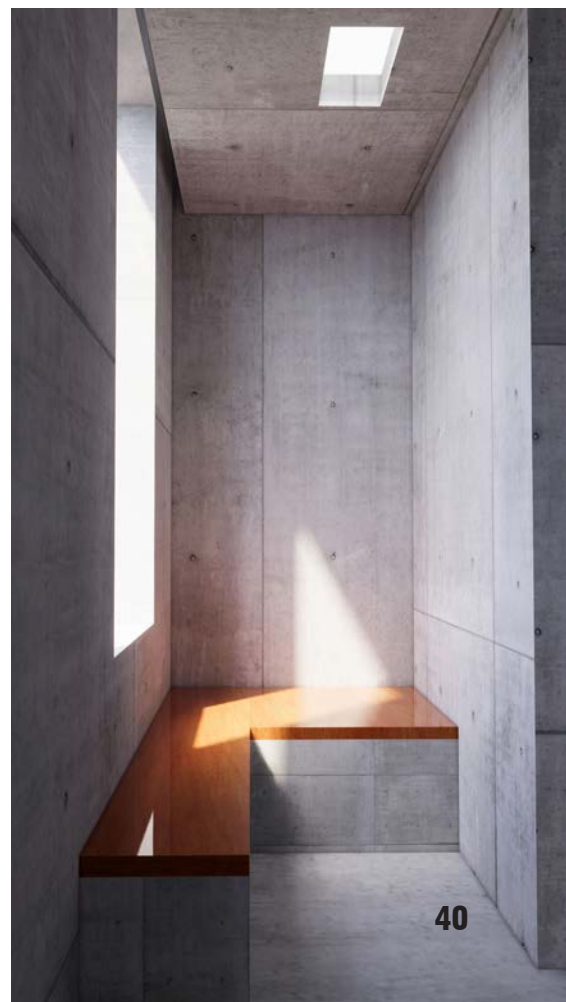



MATERIAL DETAILS

Detail Plan Views of the carved wall, stair and mosaic floor to describe the materiality of each.

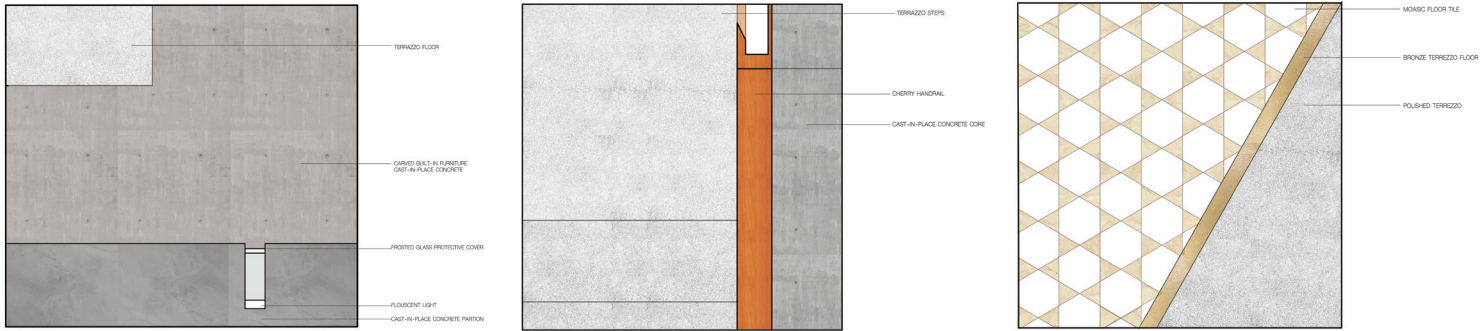



# THE THINKING HAND\*

## A selection of hand drawings and paintings.

Despite how digital the design process is becoming, I will always have a love for hand drawings. Hand sketches and drawings are important to my design process. It is where I can think through ideas the most and find I am most in **flow**.

By cropping natural light falling on the surfaces around me, I hope to inspire others to see the beauty in the everyday life around them. **Quarantine had taught me to appreciate the small moments of joy that life has to offer** and I have been inspired to **capture the ephemeral quality of light through sketches and paintings to reflect on my experience with the space around me**. No matter how seemingly-mundane and similar a space may be, there is always the ability to appreciate and find something new in it by looking with **awareness of what life has to offer**.

\*The title is in reference to Juhani Pallasmaa's *The Thinking Hand: Existential and Embodied Wisdom in Architecture*... one of favorite authors and resource for how to relate body and space.

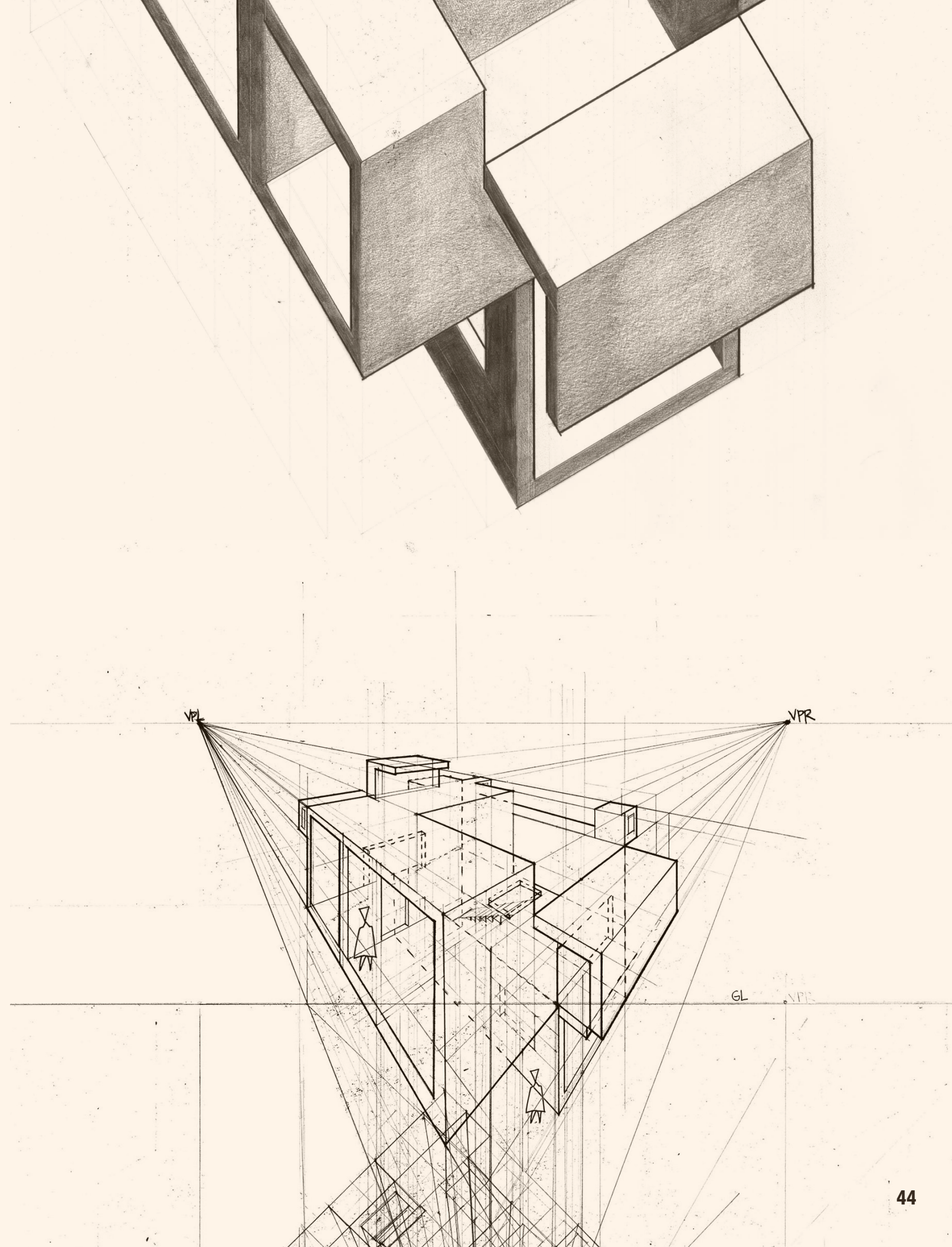
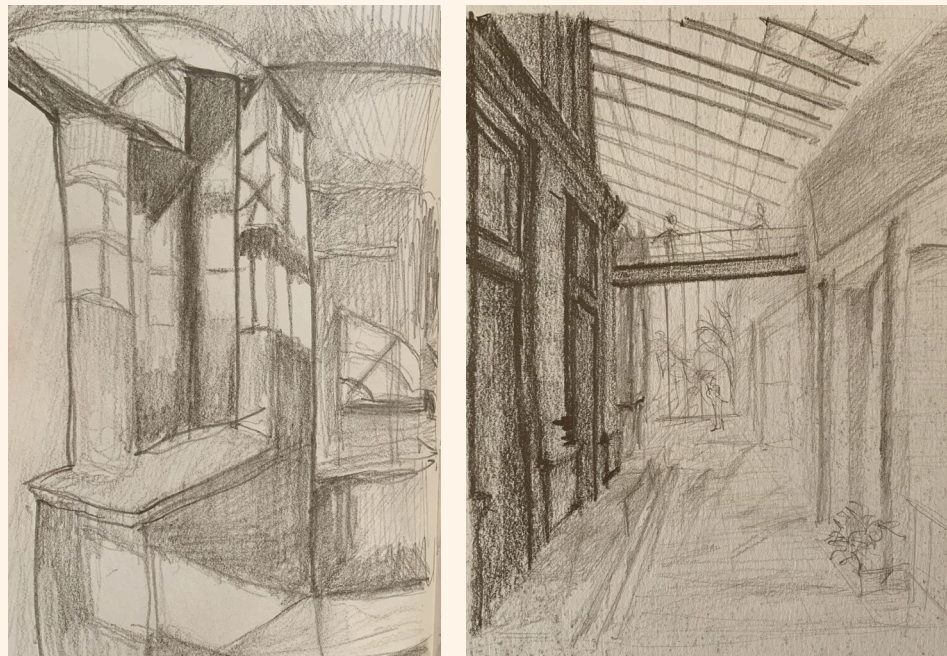



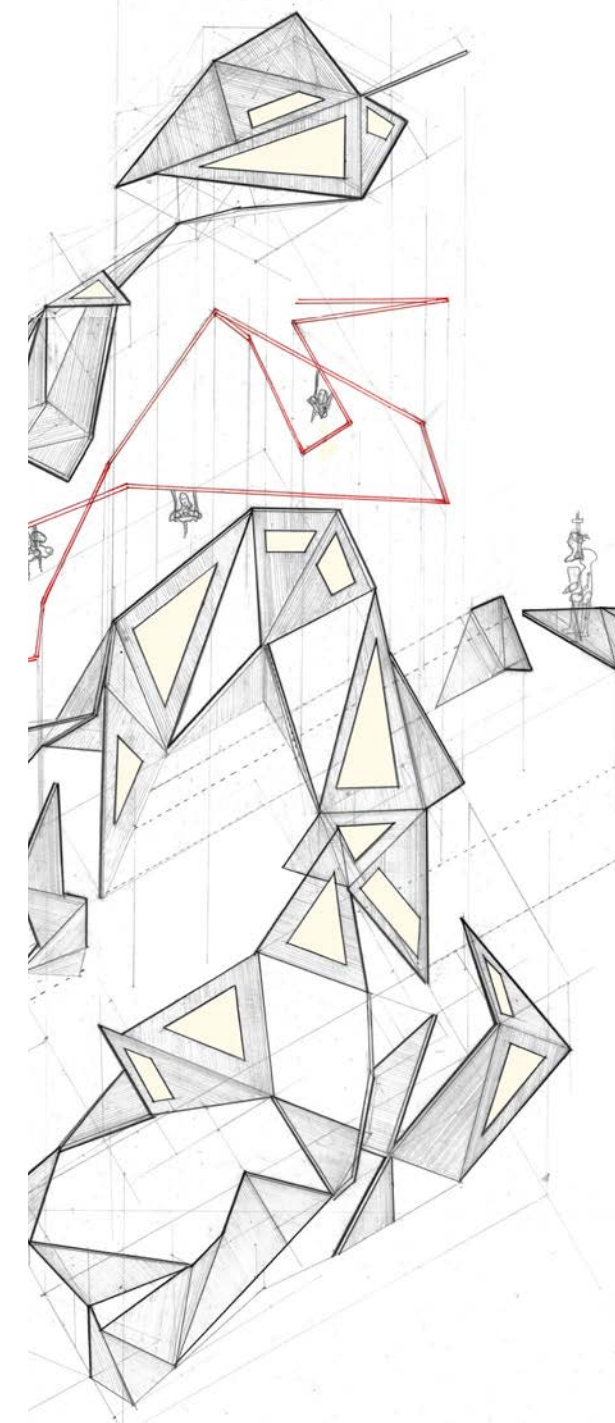
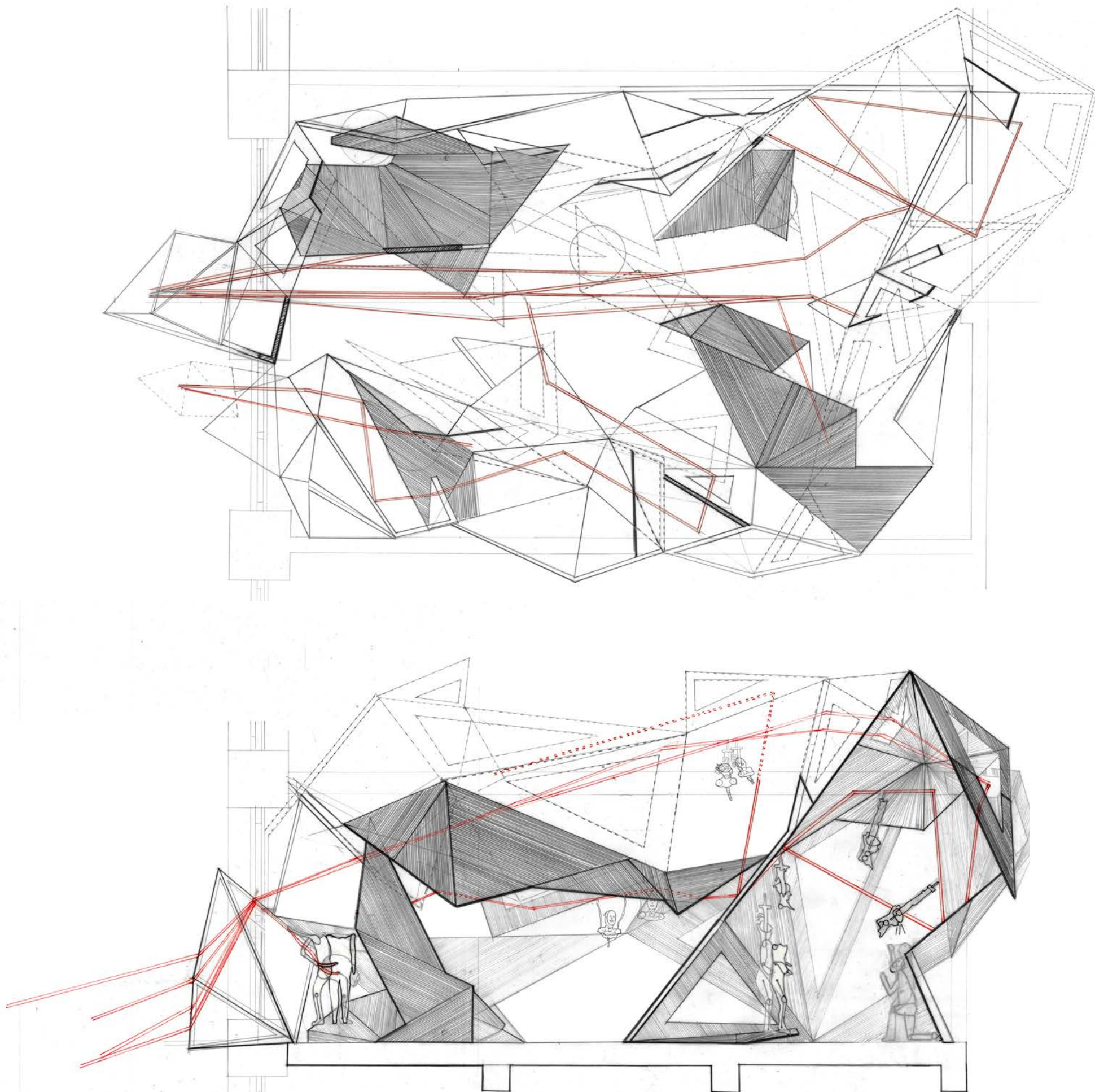
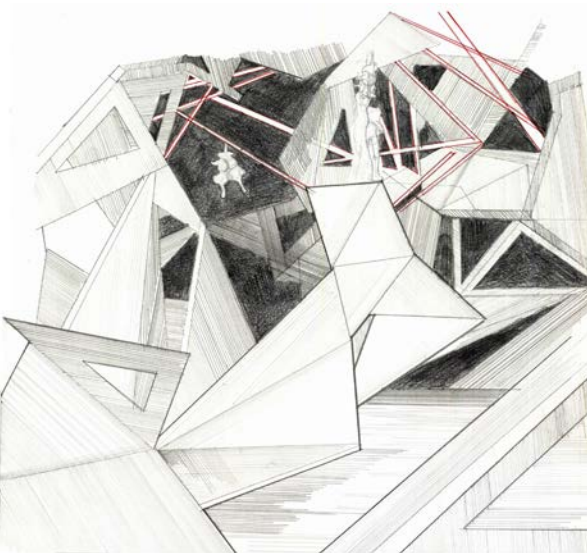
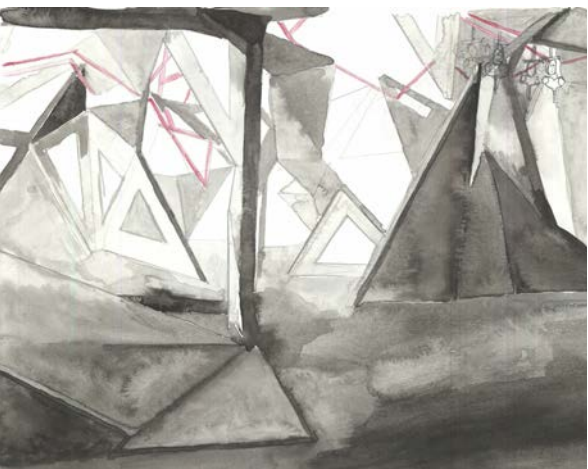



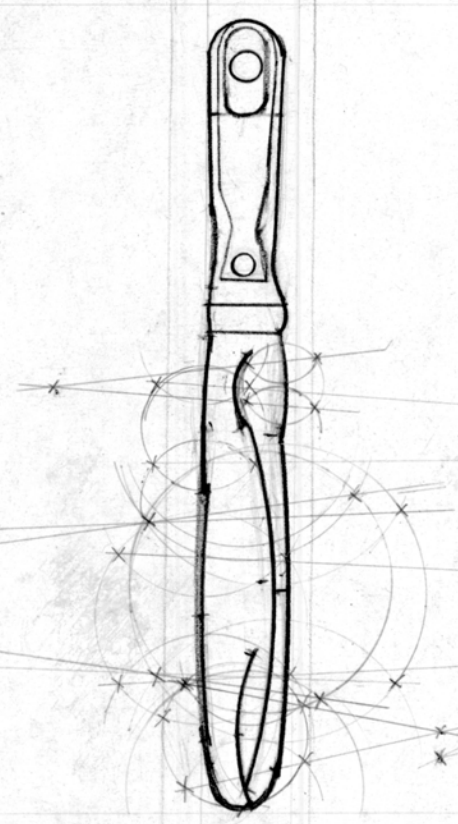

SECTION 1

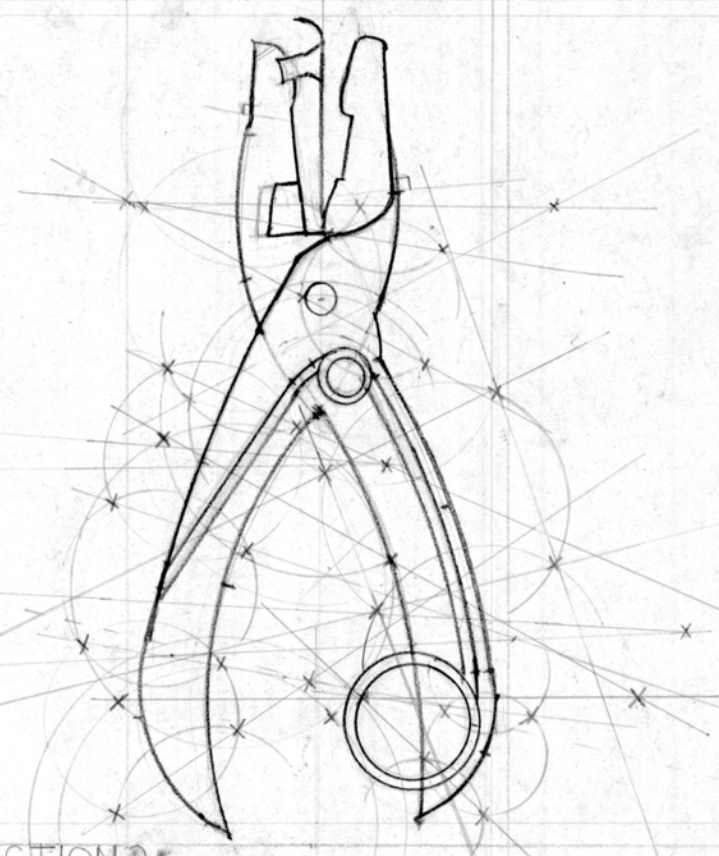

SECTION 2

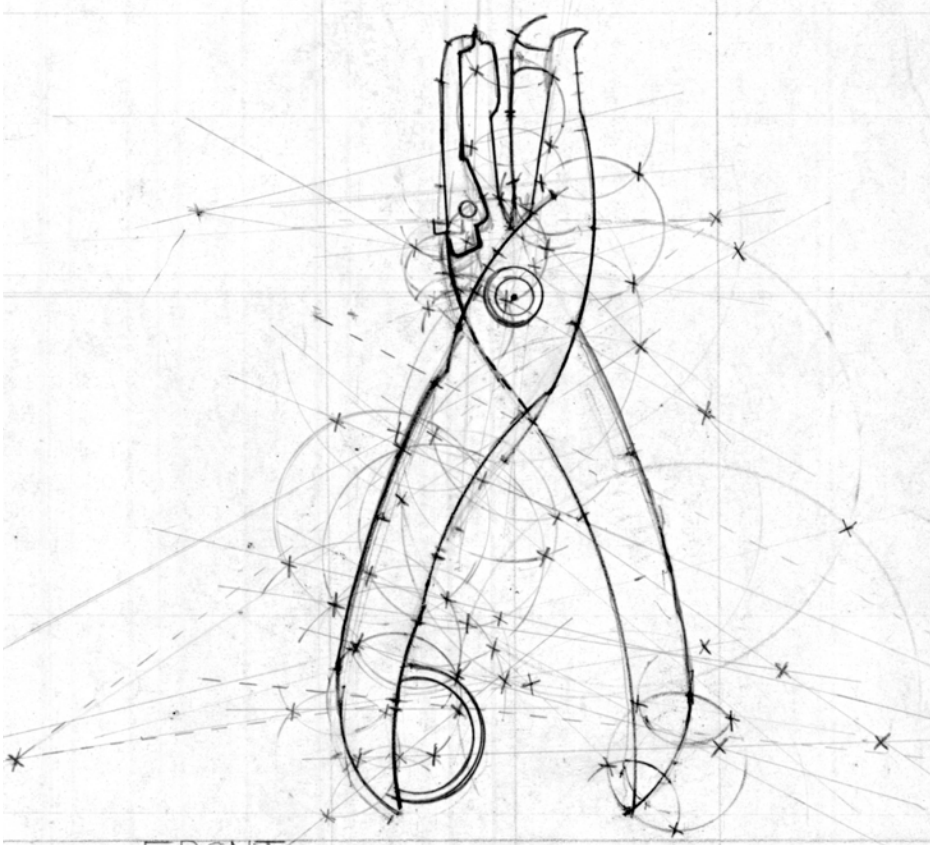

FRONT

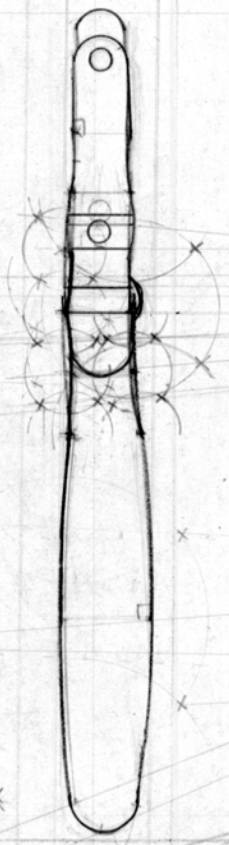

SIDE 1



BACK  
IN MOTION

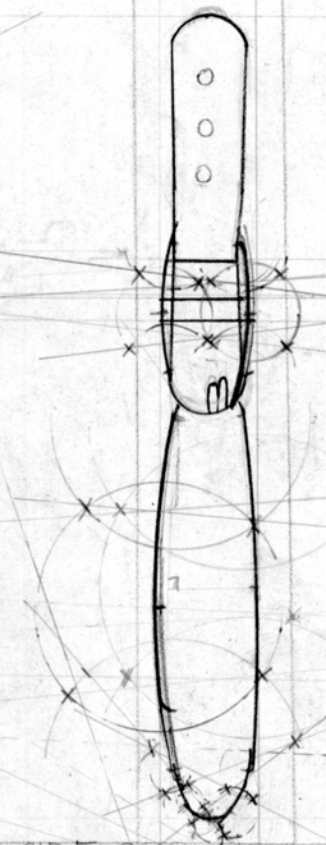

SIDE 2



